



18

Eclaté des pièces détachées

Illustrated Part Guide - Explosionszeichnung

HOBIE 18' PACIFIC



18556012 (2007) : Coque gauche
18556013 (2008) : Left hull
Rumpf links

Hobie Cat 18 Pacific Coque/Hull/Rumpf

18556017 (2007) : Coque droite
18556018 (2008) : Right hull
Rumpf rechts

Sac accastillage/Rig bag/Takelagesack = 18580400

Jeux de câbles/Cable set/Käbelsatz = 18570500 (2008)

Sac de cordages/Rope bag/Leinensack = 18570410 (2003)

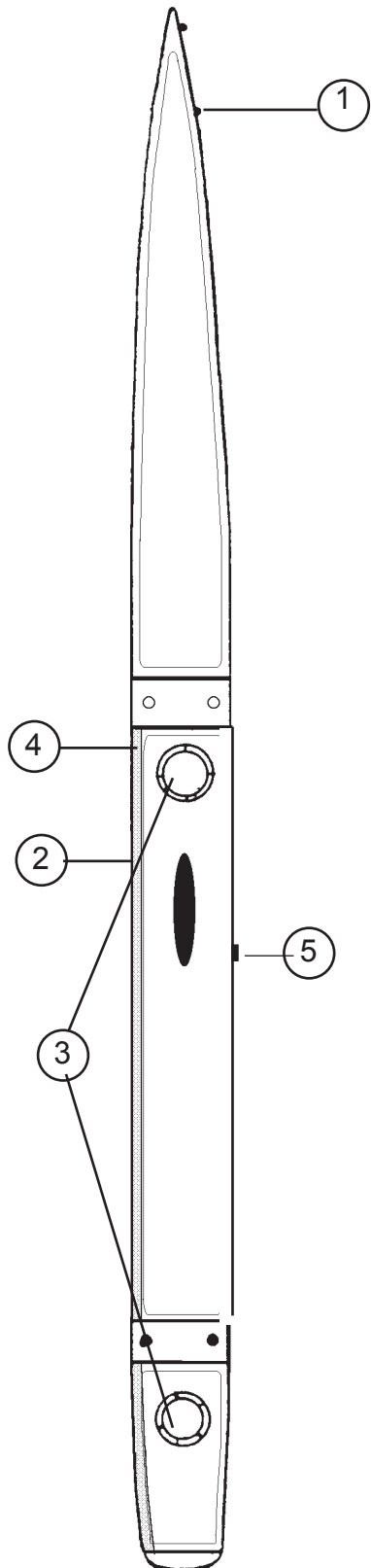

- 1 - 21060307 : Platine de bride
Bow plate
Hahnepot Platte
- 2 - 21056028 : Vis cadène
Anchor pin
Schraube für Püttingeisen
- 3 - 18056033 : Trappe de visite 127 mm
Inspection port
Lukendeckel
- 4 - 18506050 : Antidérapant x 6 + colle
Anti-skid x 6 + glue
Antirutschbelag x 6 + Kleber
- 5 - 99220215 : Pontet coque/traverse
PKG 5
Bügel für Knarrblock

Capots / Decks / Bedeckungen

18090071 = avant gauche/front left/vorne links <2008

18090072 = avant droit/front right/vorne rechts <2008

18090073 = avant/front/vorne >2008

18590075 = milieu/middle/Mittel

18090077 = arrière/rear/hinte >2008

Hobie Cat 18 Pacific Coque/Hull/Rumpf

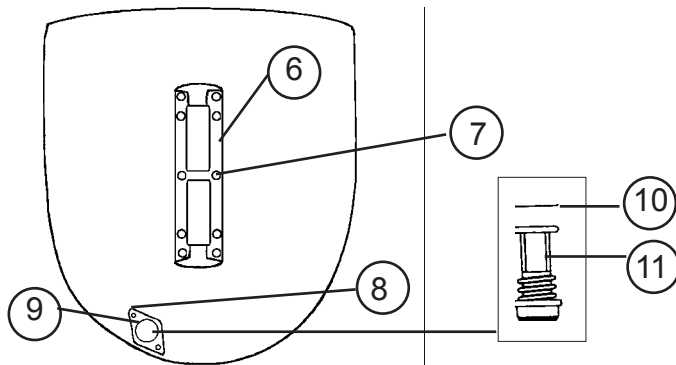

6 - 18056005:	Fémelot + entretoises Gudgeon + bushings Heckbeschlag + Büchse
7 - 99226001:	Screw TC gudgeon Schraube TC Heckbeschlag
8 - 99220074:	Vis TF bouchon PKG 10 Screw TF plug Ablassplatte-Schraube
9- 99056012:	Platine bouchon vidange Drain plug housing Platine f. Ablasschraube
10- 99220041 :	Joint bouchon vidange PKG 10 Drain plug gasket Dichtung für Ablasschraube
11- 99220040 :	Bouchon vidange PKG 10 Drain plug Ablasschraube
12- 99056190 :	Autocollant H + Hobie bleu H170 Hull sticker H + Hobie blue H170 Rumpf-Aufkleber H + Hobie blau H170
13- 99056185	Autocollant Pacific bleu 85x34 Hull sticker Pacific blue 85x34 Rumpf-Aufkleber Pacific blau 85x34
14- 99056195 :	Autocollant H bleu 20x15 Hull stickers H blue 20x15 Rumpf-Aufkleber H blau 20x15
99056023 :	Autocollant "made by Hobie" Sticket "made by Hobie" Rumpf-Aufkleber "made by Hobie"

Gouvernail droit complet/Rudder assy right complete
 Ruderanlage komplett rechts :
 blanc/white/weiss = 18562105

Hobie Cat 18 Pacific Safran/Rudder/Ruderblatt

Gouvernail gauche complet/Rudder assy compl. left
 Ruderanlage komplett links :
 Blanc/White/Weiss =18562100

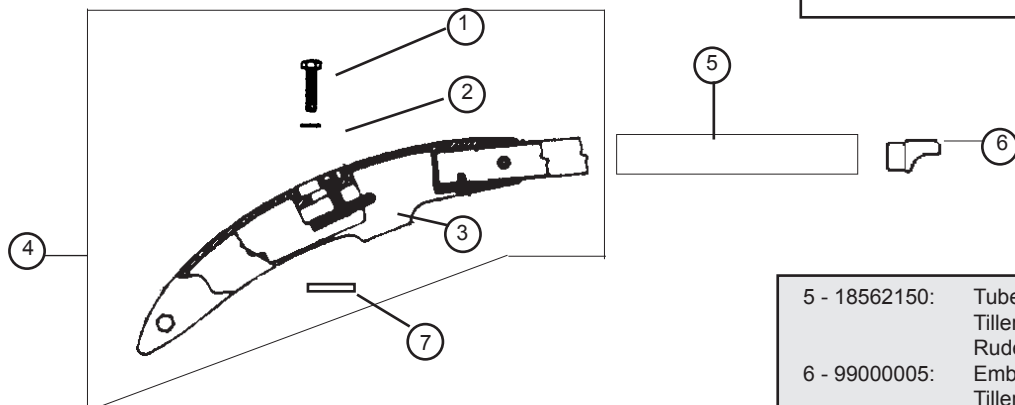

- | | |
|---------------|---------------------------|
| 1 - 99221123: | Vis TH 8x20 casting |
| PKG 10 | Cast.bolt |
| | Schraube Gußt. |
| 2 - 99061110: | Rondelle plate D8 |
| PKG 10 | Washer |
| | Unterlegscheibe |
| 3 - 17000010: | Casting supérieur Gouv. |
| | Upper rudder casting |
| | Oberes Rudergehäuse |
| 4 - 18562148: | Bras gouv.droit complet |
| | Tiller arm right complete |
| | Ruderarm rechts komplett |
| 18562147: | Bras gouv.gauche complet |
| | Tiller arm left complete |
| | Ruderarm links komplett |

- | | |
|---------------|--------------------------------|
| 5 - 18562150: | Tube de Gouvernail |
| | Tiller tube |
| | Ruderrohr |
| 6 - 99000005: | Embout à rotule |
| | Tiller end cap |
| | Pinnenendstück |
| 7 - 14061122: | Platine dural |
| | Cam stop plate |
| | Platine f. oberes Rudergehäuse |
| 8 - 14061180: | Came safran |
| PKG 10 | Plastic cam |
| | Rudernock |
| 9 - 16041755: | Goupille élastique |
| PKG 10 | Maststep pin |
| | Sprengbolzen |
| 10- 99502143: | Lame safran White Knight |
| | Ruder blade |
| | Ruderblatt |
| 11- 99220003: | Vis safran 8x60 |
| PKG 10 | Rudder bolt |
| | Schraube Ruderblatt |

Hobie Cat 18 Pacific : Eclaté de pièces détachées / Illustrated part guide/Explosionszeichnung (2009)

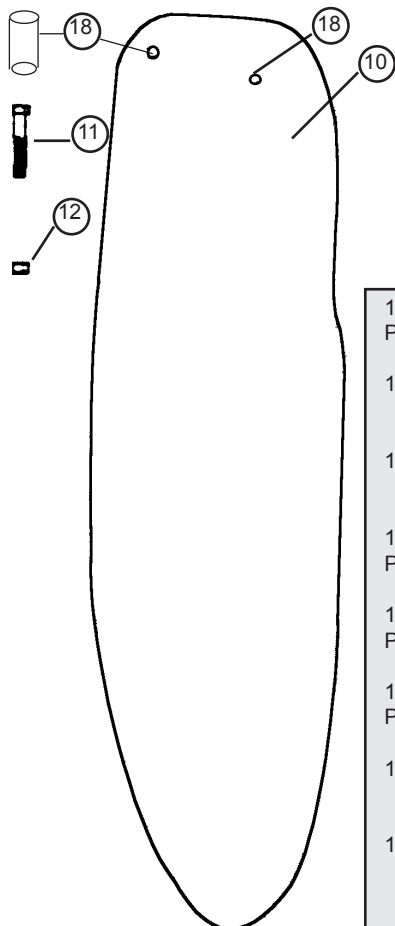

- | | |
|----------------|---------------------------------|
| 12- 99220012: | Ecrou Nylstop D8 |
| PKG 10 | Nylstop nut |
| | Selbstsichernde Mutter |
| 13- 18000155: | Casting inf. gouv néoprene |
| | Lower rudder casting + neoprene |
| | Unteres Rudergehäuse + neoprene |
| 14- 21080335 | Aiguillot + Anneau brise |
| (inox) | Rudder pin + Split ring |
| | Ruderbolzen + Ring Splint |
| 15- 14061105: | Pene safran |
| PKG 10 | Plunger |
| | Gegenstück Rudernock |
| 16- 99220004: | Ressort gouvernail |
| PKG 10 | Spring |
| | Feder |
| 17- 99220006: | Vis safran delrin |
| PKG 10 | Screw delrin rudder |
| | Schraube delrin Ruder |
| 18- 99502130: | Insert lame safran 10x8x24 |
| | Sheave pin rudder blade |
| | Bolzen Ruderblatt |
| 19- 17062680 : | Casting inférieur monté |
| | Lower rudder cast.assembled |
| | Unteres Rudergehäuse montiert |

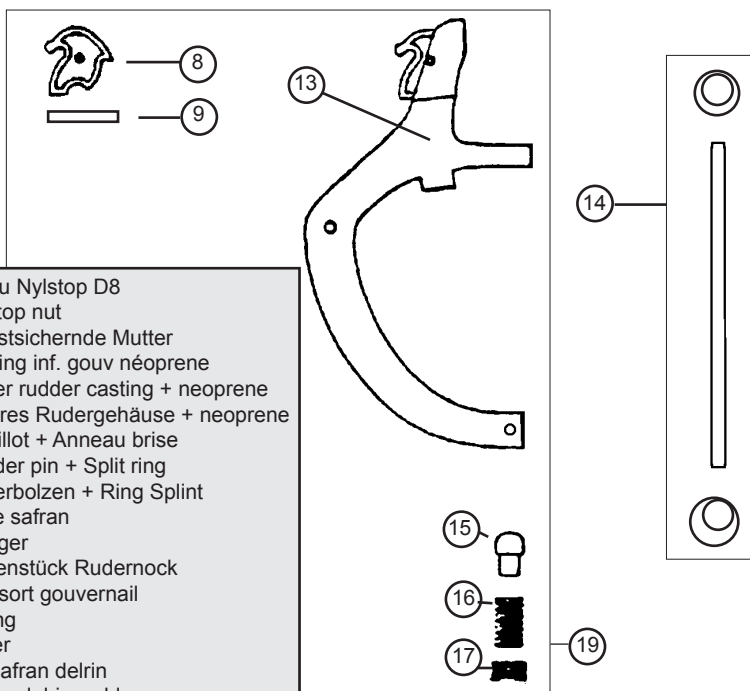

- | | |
|------------|-------------------|
| 99216010 : | Rivets 4,8 x 11 |
| (PKG 10) | Riverts 4,8 x 11 |
| | Popniete 4,8 x 11 |



Hobie Cat 18 Pacific
 Etai & drisse de foc/Forestay and jib halyard
 Vorstag und Fockfall

- 1 - 18560515 : Etai câble sans pivot 2008
Forestay wire w/o swivel
Vorstagkabel o. Wirbel
- 2 - 18060590 : Pivot étai de foc
Forestay swivel
Fockvorstagwirbel
- 3 - 18560535 (old) : Estrope + emerillon
18560530 (2003) Complete pigtail + swivel
Pigtail komplett mit Wirbel

- 7 - 18080100 : Poulie étarq. drisse de foc
Jib halyard block
Fockfallblock

- 10 - 99220034 : Axe percé latte ridoir
Clevis pin
Bolzen f. Locheisen
gebohrt
- 11 - 99220031 : Anneau brisé
Split ring

- 12 - 99220350 : Latte ridoir enrouleur
Stay adjuster
Wantenspanner
- 13 - 99300140 : Manchon D4
Sleeve
Hülse

- 4 - 18060540 : Poulie drisse de foc
Jib halyard block assy
Fockfallumlenk-Block
- 5 - 18060555 (old) : Drisse câble de foc
18560555 (2003) Jib halyard wire
Fockfall Kabel
- 6 - 99220036 : Manille lyre 4 mm
PKG 10
Shackle 4 mm
Schäkel 4 mm

- 8 - 21060150 : Enrouleur de foc
Jib furler
Fockwickler
- 9 - 18061580 (old): Bride
18061579 (2003) Bridle
Hahnepot

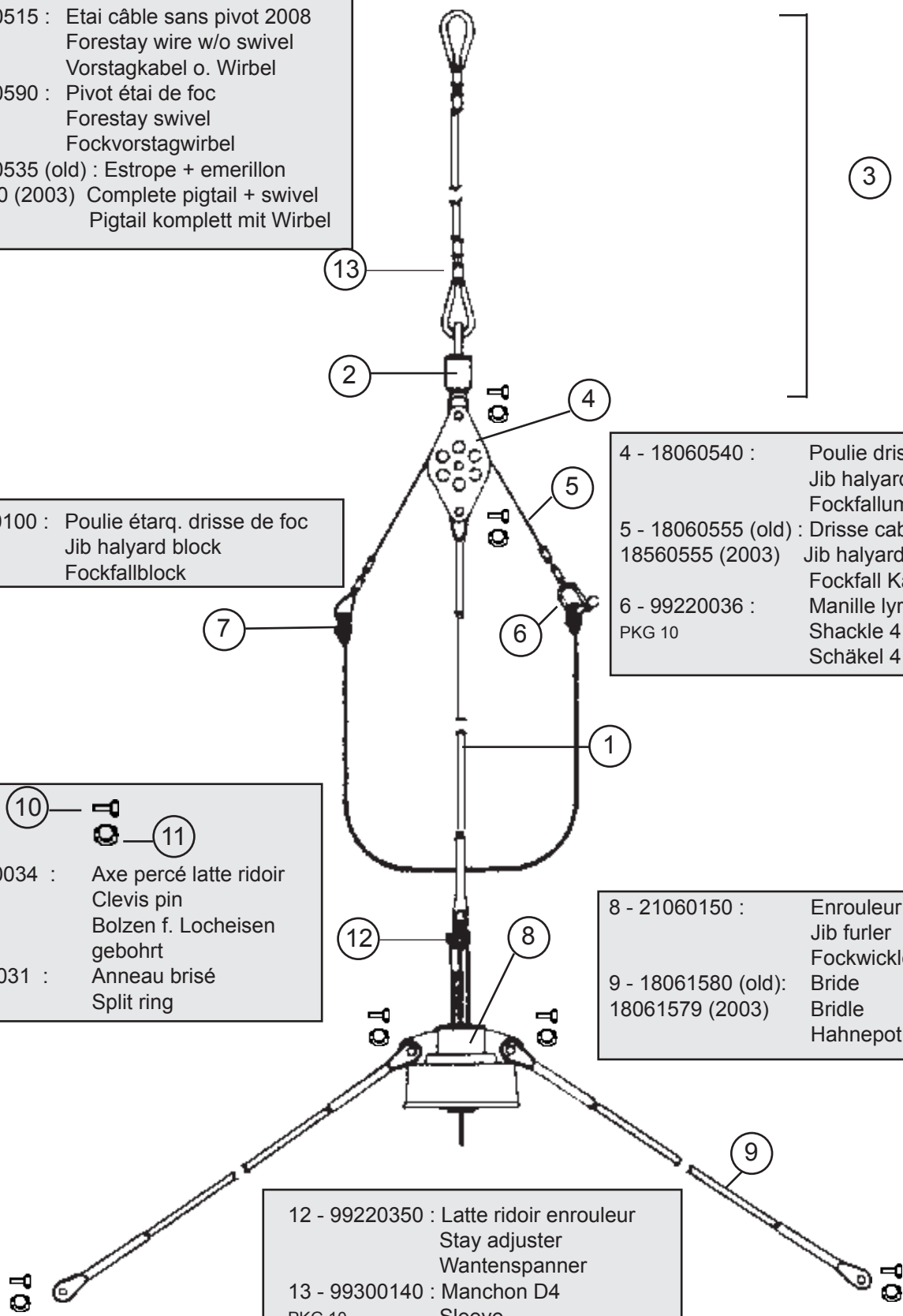

Hobie Cat 18 Pacific : Eclaté de pièces détachées / Illustrated part guide/Explosionszeichnung (2009)

Hobie Cat 18 Pacific

Trapèze/Trapeze/Trapez

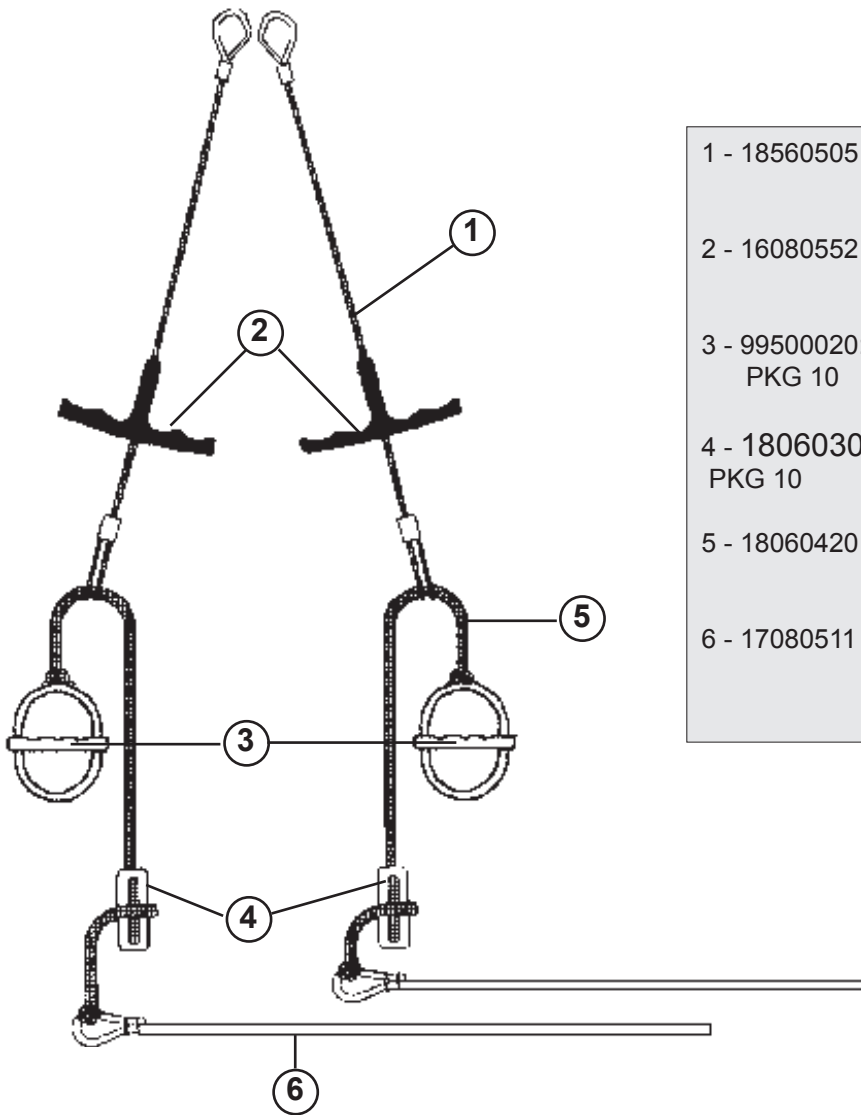

- | | |
|-------------------------|---|
| 1 - 18560505 : | Cable trapèze gainé
Coated trapeze wire
Trapezkabel überzogen |
| 2 - 16080552 : | Poignée de trapèze
Trapeze handle
Trapezgriff |
| 3 - 99500020:
PKG 10 | Poignée J&H
J&H handle
J&H Trapezgriff |
| 4 - 18060301:
PKG 10 | Double anneau
Rope lock
Trapezstopper |
| 5 - 18060420 : | Cordage D5 réglage trap.
Trapeze line D5
Trapezeleine D5 |
| 6 - 17080511 : | Sandow trapèze
Trapeze sandow
Gummistrop |

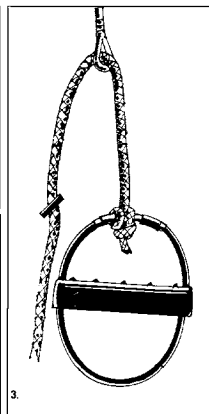
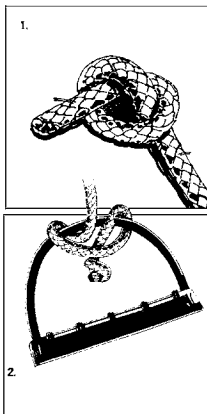

Montage des poignées de trapèze Instruction for connecting your trapeze handle Wie man die Trapezgriffe knotet

- Faire un noeud à la fin du cordage 6 mm
Tie knot firmly at end of 6 mm
Fester Knoten am Ende der Leine
- Fixer fermement la corde nouée à la poignée comme indiqué sur le dessin en s'assurant que la corde ne puisse pas glisser du milieu de la poignée.
Fix knotted rope firmly to handle as illustrated, ensuring that rope cannot move from top centre of handle.
Webleinensteck wie gezeigt fest anziehen
- Attacher normalement la corde au câble de trapèze.
Attach rope and handle to trapeze wire as normal.
Leine durch Trapezkausch und wie üblich befestigen

Hobie Cat 18 Pacific

Haubans/Shrouds/Wanten

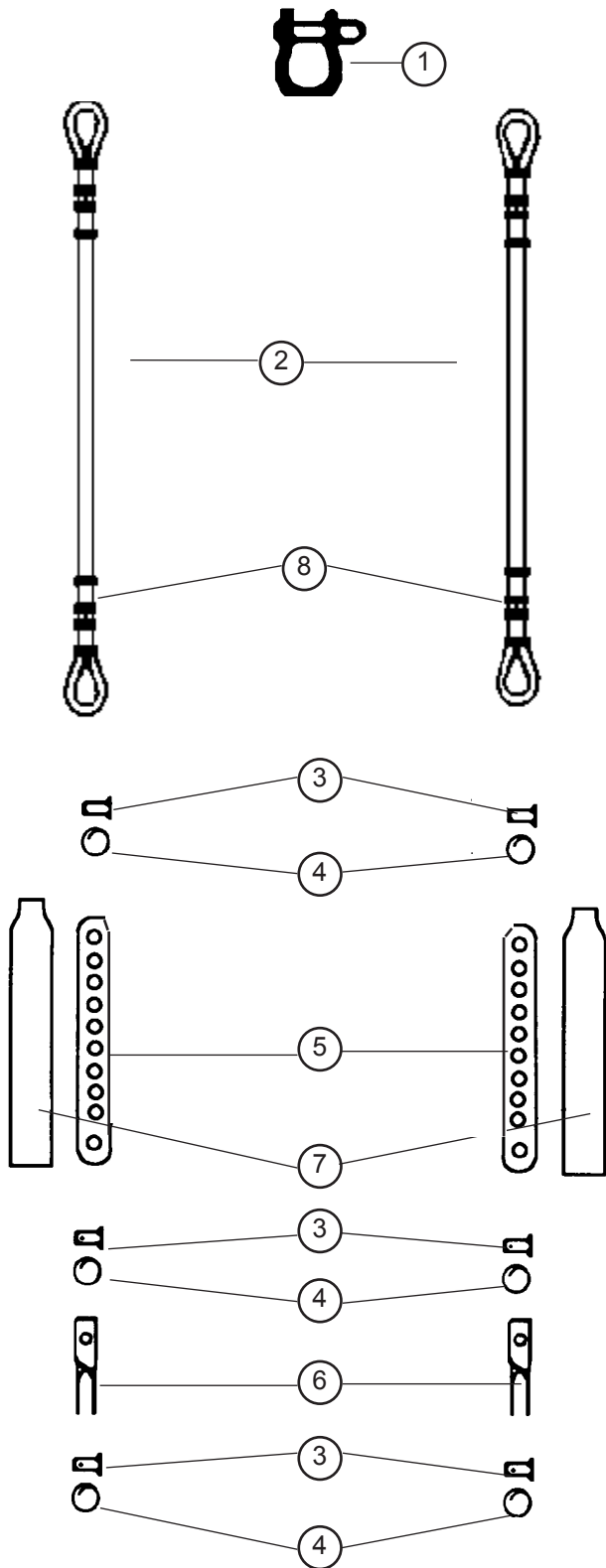

- | | |
|--|--|
| 1- 99220058:
PKG 10 | Manille Lyre 8 mm
Bow shackle
Mastschäkel |
| 2- 18560500 (old) :
18560502 (2003) | Hauban
Shroud
Want |
| 3- 99220034:
PKG 10 | Axe percé latte ridoir
Clevis pin
Bolzen für Wanteisen |
| 4- 99220031:
PKG 10 | Anneau brisé
Split ring
Ringsplint |
| 5- 99220033:
PKG 5 | Latte ridoir universelle
Stay adjuster
Wantenspanner |
| 6- 16060312:
PKG 10 | Chape de hauban
Toggle
Wanten Wirbel |
| 7- 99500360:
PKG 10 | Gaine latte ridoire
Shroud adjuster cover
Wantenschutz |
| 8 - 99300140 :
PKG 10 | Manchon D4
Sleeve
Hülse |

Hobie Cat 18 Pacific
Traverse avant/Front crossbar/Vorderholm
 18562500 (2,50 m - old)
 18062539 (2,60 m - 2003)

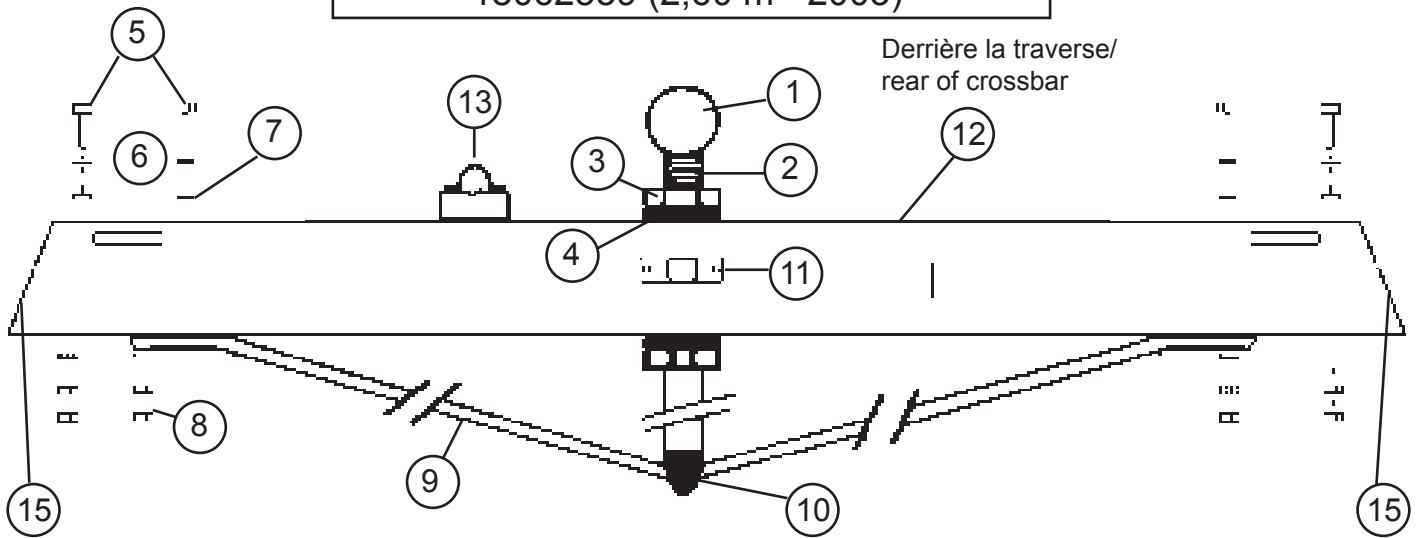

- | | |
|----------------|---|
| 1 - 21062673 : | Emplanture de mât
Mast step ball
Mastfußkugel |
| 2 - 18062680 : | Étai de martingale
Dolphin striker post
Unterzug gebohrt |
| 3 - 99220104 : | Ecrou HU D16
Nut HU D16
Mutter HU D16 |
| 4 - 99220100 : | Rondelle D16
Washer D16
Unterlegscheibe D16 |
| 5 - 99220335 : | Vis TH 10 x 150 x 50
Screw TH
Schraube TH |
| 6 - 99220059 : | Rondelle D10
Washer D10
Unterlegscheibe D10 |
| 7 - 99220260 : | Rondelle D10.2 nylon
Nylon washer D10.2
Nylon Unterlegscheibe D10.2 |
| 8 - 99220009 : | Ecrou HU D10
Nut HU D10
Mutter HU D10 |

- | | |
|------------------------|---|
| 9 - 18562700 (2,50m) : | Martingale HC18Ti |
| 18062700 (2,60m) : | Dolphinstriker HC18Ti
Unterzug HC18Ti |
| 10- 21000010 : | Support étau de martingale
striker bar fastening
Unterzug Fuß |
| 11- 16056025 : | Articulation inox tangon
Spi pole articulation inox
Verbindung Spibaum inox |
| 12- 99500415 : | Taquet enrouleur
Furler cleat
Wicklerklemme |
| 13- 99500467 : | Tourelle Taquet carbo
Swivel Camcleat
Drehklemme |
| 18580060 : | Glissière de foc droite
Fock swivel cleat slider right
Fockdrehklemmeleits rechts |
| 18580055 : | Glissière de foc gauche
Fock swivel cleat slider left
Fockdrehklemmeleits links |
| 14- 18062742 : | Bouchon traverse droit
Beam cap right
Vorderholmendstück rechts |
| 15- 18062741 : | Bouchon traverse gauche
Beam cap left
Vorderholmendstück links |

Hobie Cat 18 Pacific
 Traverse arrière/Rear crossbar
 Achterholm
 18562570 (2,50 m - old)
 18562580 (2,60 m - 2003)

- | | |
|----------------|---|
| 1 - 99220335 : | Vis TH 10 x 150 x 50
Crossbar bolt
Holmbolzen |
| 2 - 99220059 : | Rondelle D10
Washer D10
Unterlegscheibe D10 |
| 3 - 99220260 : | Rondelle D10.2 nylon
Nylon washer D10.2
Nylon Unterlegscheibe D10.2 |
| 4 - 99220009 : | Ecrou HU D10
Nut HU D10
Mutter HU D10 |
| 5 - 18062744 : | Bouchon traverse AR droit
Beam end cap rear right
Achterholmendstück hint. rechts |
| 6 - 18062743 : | Bouchon traverse AR gauche
Beam end cap rear left
Achterholmendstück hint. links |

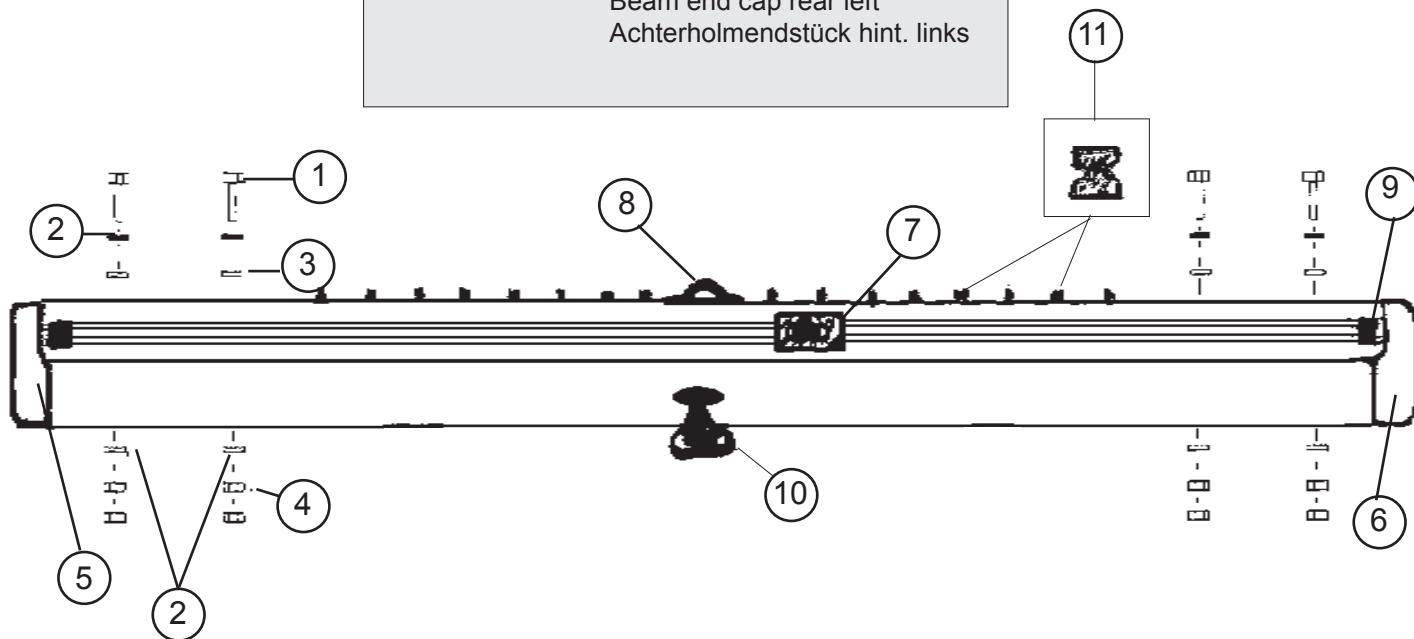

- | | |
|----------------|--|
| 7 - 99500255 : | Chariot de grand-voile
Traveller car
Großtraveller |
| 21060056 : | Jeu billes chariot GV
Ball bearing traveller car |
| 8 - 99220057 : | Pontet forgé D5
Eye strap
Guseisenbeschlag |

- | | |
|----------------|---|
| 9 - 21062521 : | Embout rail d'écoute grand voile
Traveller track end stop
Travellerschiene Endstück |
| 10- 99500350 : | Tourelle
Swivel Camcleat
Drehklemme |
| 11- 99500700 : | Crochet de laçage trampoline
Trampoline lacing post (x16) |

Hobie Cat 18 Pacific
 Barre d'accouplement / Tiller crossbar
 Anlenkstange / **18562200 (2,50m old)**
18562300 (2,60 - 2003)

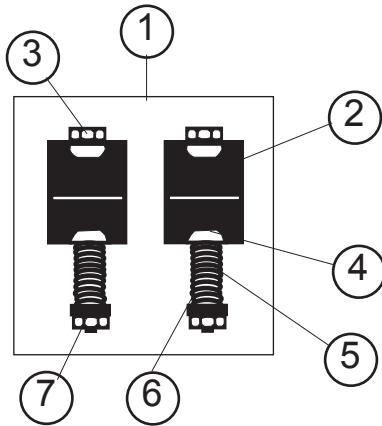

- 1 - 99500380: Kit d'articulation TCM LE
Tiller connector kit LE
Verbindungsgelenk LE
- 2 - 99500331: Demi-pallier
Rubber spacer
Distanzhülse
- 3 - 99220027: Vis TH 6 x 50
PKG 10
TH screw
TH Schraube
- 4 - 99220029: Demi-bille nylon
pkg 20
Half ball nylon
Nylon Halbkugel
- 5 - 99500335: Ressort TCM
PKG 10
TCM spring
TCM-Feder

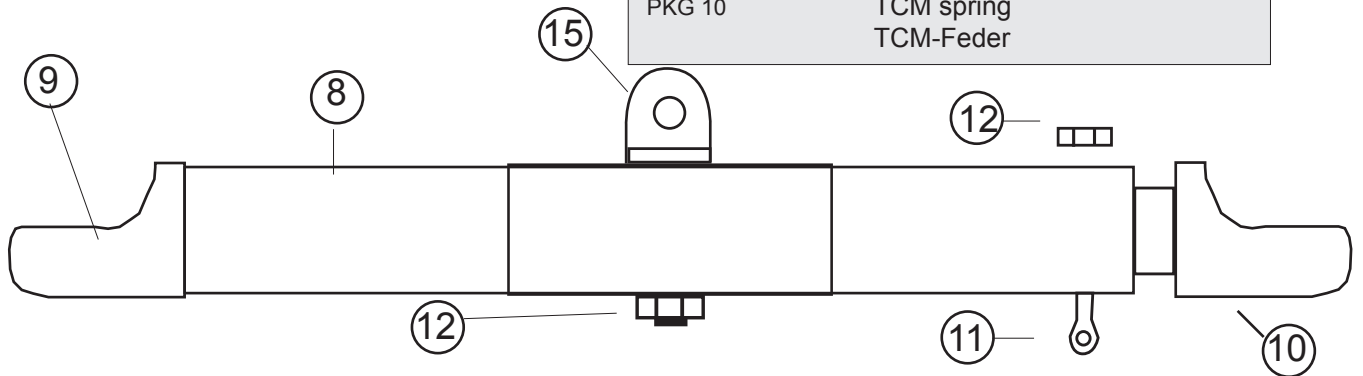

- 6 - 99220032: Rondelle inox
PKG 10
Stainless washer
Unterlegscheibe
- 7 - 99220019: Ecrou indessérable D6
PKG 10
Nylstop nut D6
Selbstsichernde Mutter D6
- 8 - 18562200 : Barre accoupl.avec renfort
Tiller crossbar with sleeve
Anlenkstange
- 9 - 99000005 : Embout à rotule
Tiller End Cap
Pinnenendstück
- 10 - 99000010 : Coulisseau réglage accpt
Adjustable Tiller
Eingerichtet Gleiter
- 11 - 99220010: Vis manillon
PKG 10
Tiller adjusting screw
Schraube

- 12 - 99220012: Ecrou indessérable D8
PKG 10
Nylstop nut D8
Selbstsichernde Mutter D8
- 13 - 14061240 : Axe percé
PKG 10
Clevis pin
Bolzen für Pinnenausleger
- 14 - 99220031 : Anneau brisé
PKG 10
Split ring
Ringsplit
- 15 - 14061320 : Chape articulation stick
PKG 10
Stick articulation
Pinnengelenk
- 16 - 14061310 : Embout stick fibre
PKG 10
Fibreglas extension tip
Pinnenendstück Fibreglas
- 17 - 18062315 : Stick fibre de verre magnum
Fibreglas tiller extension magnum
Pinnenauslege Fibreglas Magnum

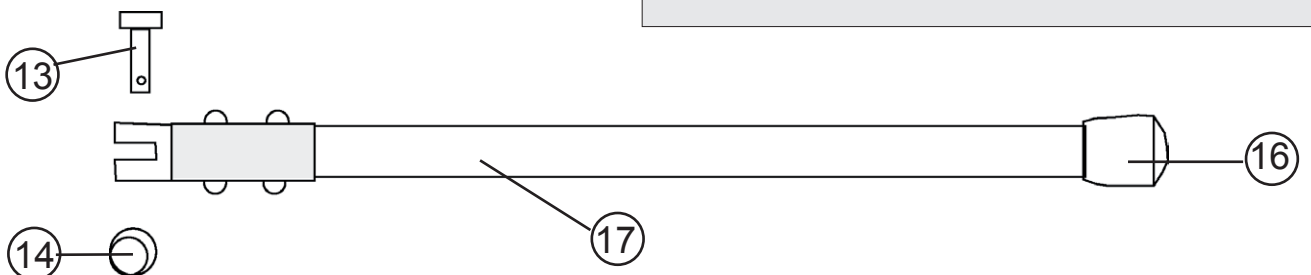

Hobie Cat 18 Pacific

Enrouleur/Jib furler/Fockroller

21060150

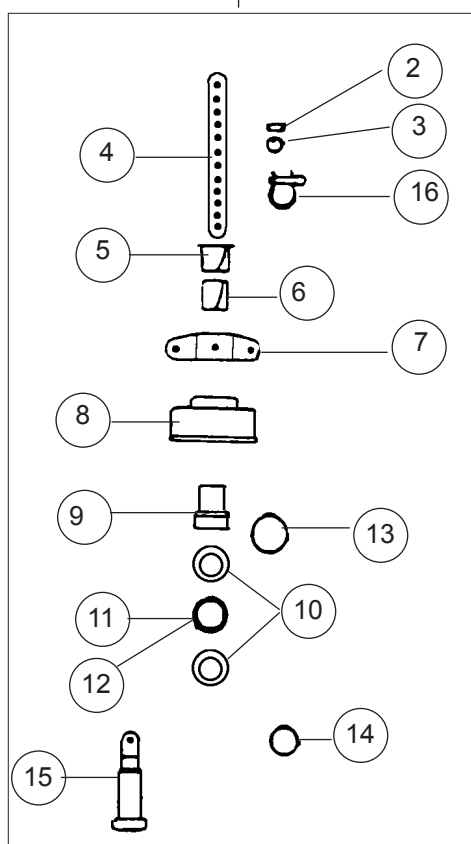
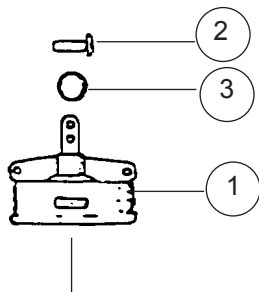

- | | |
|---------------------------|--|
| 1 - 21060150 : | Enrouleur
Jib furling assembly
Fockroller |
| 2 - 99220034 :
PKG 10 | Axe percé latte ridoir
Clevis pin
Bolzen für Locheisen |
| 3 - 99220031:
PKG 10 | Anneau brisé
Split ring
Ringsplint |
| 4 - 99220350 : | Latte ridoire enrouleur
Furling stay adjuster
Fockroller-Stagspanner |
| 5 - 21060151 : | Entretoise nylon supérieure
Upper nylon bushing
Obere Nylon Hülse |
| 6 - 21060152 : | Entretoise nylon inférieure
Lower nylon bushing
Untere Nylon Hülse |
| 7 - 21060590 : | Coupleur à brides
Yoke
Hahnepotverkappung |
| 8 - 21060153 : | Carter plastic + bobine
Housing + spool
Plastikgehäuse + Trommel |
| 9 - 21060157 : | Entretoise métal
Sleeve
Metallhülse |
| 10 - 21060158 : | Flasque roulement
Bearing race
Kugellagerseitenwand |
| 11 - 21060154 : | Cage de roulement
Bearing cage
Kugellager Gehäuse |
| 12 - 21060156 :
PKG 10 | Bille de roulement
Bearings
Kugellager |
| 13 - 21060305 : | Circlips grand modèle
Darby ring large
Offener Ring groß |
| 14 - 21060306 : | Circlips petit modèle
Darby ring small
Offener Ring klein |
| 15 - 21060313 : | Axe principal
Tube
Hauptachse |
| 16 - 99220035 :
PKG 10 | Manille lyre D6
Shackle D6
Schäkel D6 |

**Mât Pacific avant 2003/
Pacific mast before 2003**

Hobie Pacific
Barre de flèche et câbles
Spreader and diamond wires
Saling und Diamondwant

18060331 : KIT BARRE DE FLECHE
SPREADER ASSEMBLY
SALING BAUSATZ

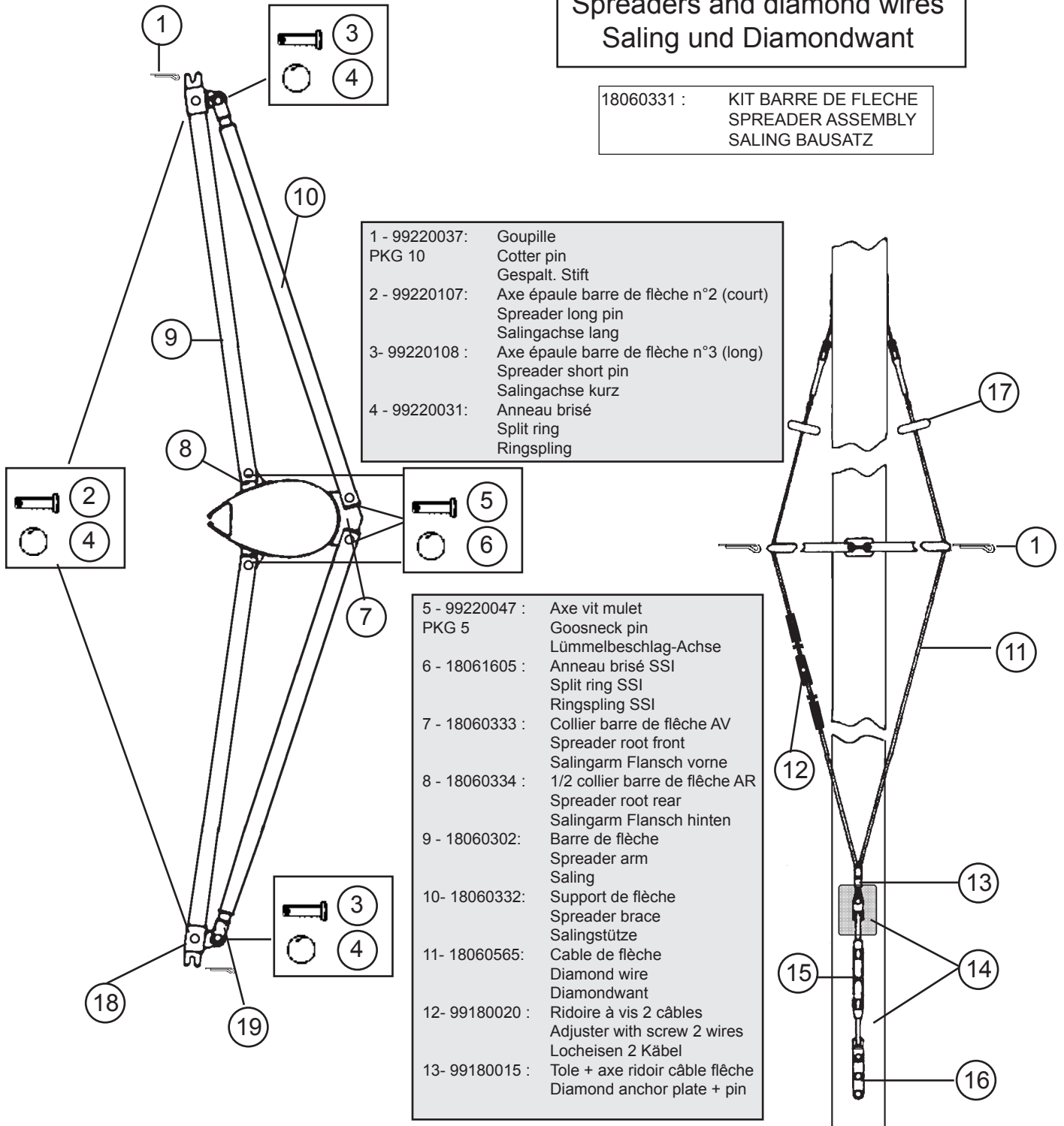

- 1 - 99220037: Goupille
Cotter pin
Gespalt. Stift
- 2 - 99220107: Axe épaule barre de flèche n°2 (court)
Spreader long pin
Salingachse lang
- 3 - 99220108 : Axe épaule barre de flèche n°3 (long)
Spreader short pin
Salingachse kurz
- 4 - 99220031: Anneau brisé
Split ring
Ringspling

- 5 - 99220047 : Axe vit mulet
Goosneck pin
Lümmelbeschlag-Achse
- 6 - 18061605 : Anneau brisé SSI
Split ring SSI
Ringspling SSI
- 7 - 18060333 : Collier barre de flèche AV
Spreader root front
Salingarm Flansch vorne
- 8 - 18060334 : 1/2 collier barre de flèche AR
Spreader root rear
Salingarm Flansch hinten
- 9 - 18060302: Barre de flèche
Spreader arm
Saling
- 10- 18060332: Support de flèche
Spreader brace
Salingstütze
- 11- 18060565: Câble de flèche
Diamond wire
Diamondwant
- 12- 99180020 : Ridoire à vis 2 câbles
Adjuster with screw 2 wires
Locheisen 2 Kabel
- 13- 99180015 : Tole + axe ridoir câble flèche
Diamond anchor plate + pin

- 14- 99180010 : Tole réglage câble de flèche
Shield plate
Einstellplatte
- 15- 99180005 : Ridoir à vis câble de flèche
Turnbuckle
Salingspanner
- 16- 18080501: Barette ridoir
Turnbuckle anchor plate
Salingspanner-Verankerung

- 17- 18034111: Kit protège foc Trentec
Plastic roller-diamond wire
Kit Fockschutz Trentec
- 18- 18011801: Tube de réglage barre de flèche
Spreader slide
Salingeinstellrohr
- 19- 99220106: Vis de réglage barre de flèche
spreader tip adjuster
Salingendstück-Einstellschraube



**Mât Pacific depuis 2003/
Pacific mast since 2003**

**Hobie Cat 18 Pacific
Barre de flèche et cables
Spreaders and diamond wires
Saling und Diamondwant**

99064050 : KIT BARRE DE FLECHE cplt
SPREADER ASSEMBLY
SALING BAUSATZ

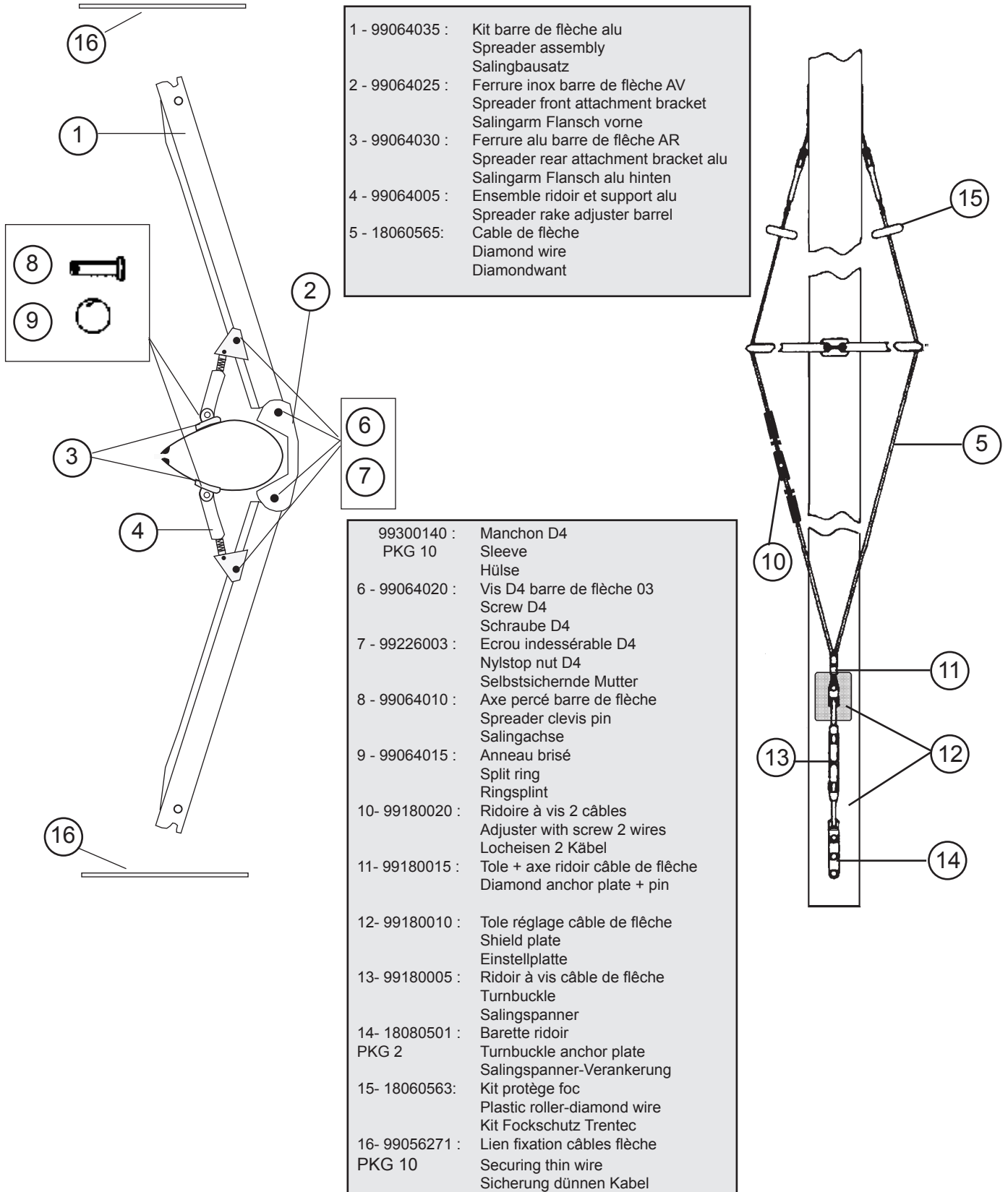

- 1 - 99064035 : Kit barre de flèche alu
Spreader assembly
Salingbausatz
- 2 - 99064025 : Ferrure inox barre de flèche AV
Spreader front attachment bracket
Salingarm Flansch vorne
- 3 - 99064030 : Ferrure alu barre de flèche AR
Spreader rear attachment bracket alu
Salingarm Flansch alu hinten
- 4 - 99064005 : Ensemble ridoir et support alu
Spreader rake adjuster barrel
- 5 - 18060565 : Cable de flèche
Diamond wire
Diamondwant

- 99300140 : Manchon D4
PKG 10 Sleeve
Hülse
- 6 - 99064020 : Vis D4 barre de flèche 03
Screw D4
Schraube D4
- 7 - 99226003 : Ecrou indessérable D4
Nylstop nut D4
Selbstsichernde Mutter
- 8 - 99064010 : Axe percé barre de flèche
Spreader clevis pin
Salingachse
- 9 - 99064015 : Anneau brisé
Split ring
Ringsplint
- 10- 99180020 : Ridoir à vis 2 câbles
Adjuster with screw 2 wires
Locheisen 2 Kabel
- 11- 99180015 : Tole + axe ridoir câble de flèche
Diamond anchor plate + pin
- 12- 99180010 : Tole réglage câble de flèche
Shield plate
Einstellplatte
- 13- 99180005 : Ridoir à vis câble de flèche
Turnbuckle
Salingspanner
- 14- 18080501 : Barette ridoir
PKG 2 Turnbuckle anchor plate
Salingspanner-Verankerung
- 15- 18060563 : Kit protège foc
Plastic roller-diamond wire
Kit Fockschutz Trentec
- 16- 99056271 : Lien fixation câbles flèche
PKG 10 Securing thin wire
Sicherung dünnen Kabel



18542700 : Mât complet **avant 2003**
 Complete mast prior 2003
 Mast komplett bevor 2003

Hobie Cat 18 Pacific Mât/Mast/Mast

- 1 - 16000005 : Tête de mât noire
Black mast head
Mastkopf schwarz
- 2 - 16041753 : Sceau de mât
Mast plug
Mast-Abdichtung
- 3 - 18541720 : Crochet de drisse
Halyard hook
Fallhaken
- 4 - 99500114 : Poulie simple Harken
Harken single block
Block Harken einfach
- 5 - 99220057 : Pontet forgé D5
Eye strap
Guseisenbeschlag
- 6 - 18041721 : Collier de spi
Mast tang spi
Mastbeschlag Spi
- 7 - 21041720 : Ferrure de capelage
Mast tang
Mastbeschlag
- 8 - 21080511 : Barrette cable de flèche
Diamond wire holder
Salingdraht-Mastbeschlag
- 9 - 18060333 : Collier barre de flèche AV
Spreader root forward
Saling Ringflansch vorder
- 10 - 18060334 : Collier barre de flèche AR
Spreader root aft
Saling Ringflansch hinten
- 11- 99220050 : Taquet de drisse
PKG 10
Halyard cleat
Niederholer-Mastklemme
- 12- 99500540 : Taquet aluminium
Clamcleat aluminium
Klemme aluminium
- 13- 14041723 : Autocollant de sécurité
Mast caution label
Sicherheitsaufkleber
- 14- 17041750 : Réa de vit mullet
Gooseneck sheave
Lümmelbeschlag Rolle
- 15-99500332 : Vis 6x60
PKG 10
Screw 6x60
Schraube 6x60
- 16- 99220094 : Vis 6x80
Screw 6x80
Schraube 6x80
- 17- 99220019 : Ecrou nylstop 6
PKG 10
Nylstop nut 6
Selbstsichernde Mutter 6
- 18- 18000050 : Base de mât
Mast base
Mastfußpfanne
- 19- 18080501 : Barrette ridoire câble de flèche
PKG 2
Turnbuckle anchor plate
Salingspanner-Platte
- 20- 99180010 : Tôle réglable câble de flèche
Bottlescrew shield plate
Salingspanner-Schutzplatte
- 21- 18541750 : Drisse câble grand-voile
Main halyard wire
Großfall-Kabel

- 22- 18062717 : Plaque compression
Compression sheet
Metalplatte
- 23- 18041780 : Entretoise mat
Mast bushing
Mast Huelse
- 24- 18011865 : Embase vit mullet
Gooseneck base
Maststück f. Lümmelbeschlag

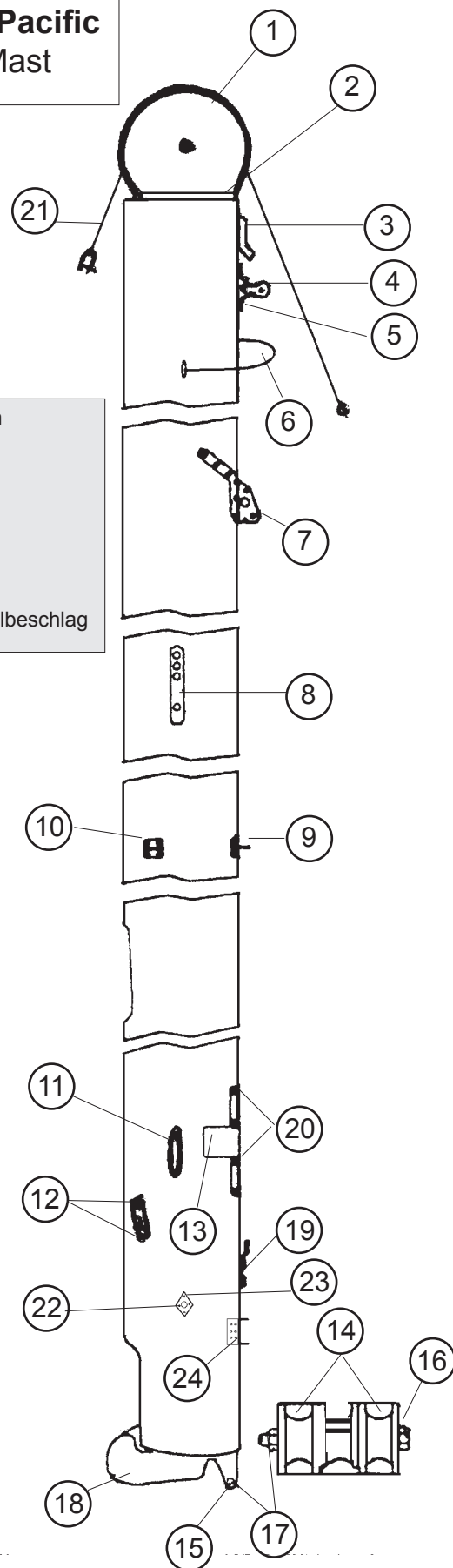

depuis/since/ab
2003

Hobie Pacific
Mât/Mast/Mast

18542710 : Mât complet ss tourelle
Complete mast w/o block
Mast komplett o. Cunningham
18542750 : Mât 2 pièces
2piece mast
2teiliger Mast
18542760 : Mât Sport 2003
Sport Mast 2003

- 1 - 16000005 : Tête de mât noire
Black mast head
Mastkopf schwarz
- 2 - 16041753 : Sceau de mât
Mast plug
Mast-Abdichtung
- 3 - 18541720 : Crochet de drisse
Halyard hook
Fallhaken
- 4 - 18541750 : Drisse câble grand-voile
Main halyard wire
Großfall-Kabel
- 5 - 99220238 : Ferrure fixation trav & mât
Tang fixation crossbar & mast
Beschlag f. Befestigung Helm & Mast
- 6 - 99300565 : Cordage D4 noir
Mast rope D4 black
Mastleine D4 schwarz
- 7 - 18060408 : Drisse de grand-voile
Main halyard rope
Großfalleine
- 8 - 21041720 : Ferrure de capelage
Mast tang
Mastbeschlag
- 9 - 21080511 : Barrette cable de flèche
Diamond wire holder
Salingdraht-Mastbeschlag
- 10 - 99064025 : Ferrure inox barre flèche
Inox spreader anchor plate
Saling Inox Platte
- 11 - 99064030 : Ferrure alu barre flèche
Spreader anchor plate alu
Saling Alu Platte
- 12 - 17060302 : Bras de rotation de mât
Mast rotator
Rotationsarm
- 13 - 18062717 : Plaque de compression
Mast rotator compression plate
Rotationsarm-Mastplatte
- 14-99220012 : Ecrou indesserrable D8
PKG 10
Nylstop nut
Selbstsichernde Mutter
- 15- 99220307 : Vis TH 8x110
PKG 10
Schraube TH 8x110
- 16- 18011865 : Embase de vit mulet
Gooseneck base
Lümmel-Mastbeschlag
- 17- 99220311 : Vis TH 6x35
PKG 10
TH Screw
Schraube TH
- 18- 99220019 : Ecrou nylstop 6
PKG 10
Nylstop nut 6
Selbstsichernde Mutter 6
- 19- 14041723 : Autocollant de sécurité
Mast caution label
Sicherheitsaufkleber
- 20- 99080540 : Tourelles cunningham
Dowhaul swivel camcleat
Drehklemme Vorliekstrecker
- 21- 17041750 : Réa de vit mulet
Gooseneck sheave
Lümmelbeschlag Rolle
- 22- 99500332 : Vis 6x60
PKG 10
Screw 6x60
Schraube 6x60
- 23- 99220022 : Vis 6x70
Screw 6x70
Schraube 6x70

RIVET / POP PKG 10

- 99210050 : Rivet bouchon étanches/watertight rivets
- 99216004 : Rivet / Pop 4,8 x 19
- 99216010 : Rivet / Pop 4,8 x 11

- 24-18000050 : Base de mât
Mast base
Mastfußpfanne
- 25- 14061245: Axe barre 6x32
Tiller connection pin
Anlenkstange Bolzen
- 26- 99500114 : Poulie simple tangon 28 mm
Pole single block
Einfacher Block Spibaum
- 27- 18080501 : Barrette ridoire câble de flèche
PKG 2
Turnbuckle anchor plate
Salingspanner-Platte
- 28- 99180010 : Tôle réglable câble de flèche
Bottlescrew shield plate
Salingspanner-Schutzplatte
- 99220050 : Taquet de drisse/Halyard cleat/Fall-Klemme
- 99221125 (PKG10) : Vis/Screw/Schraube

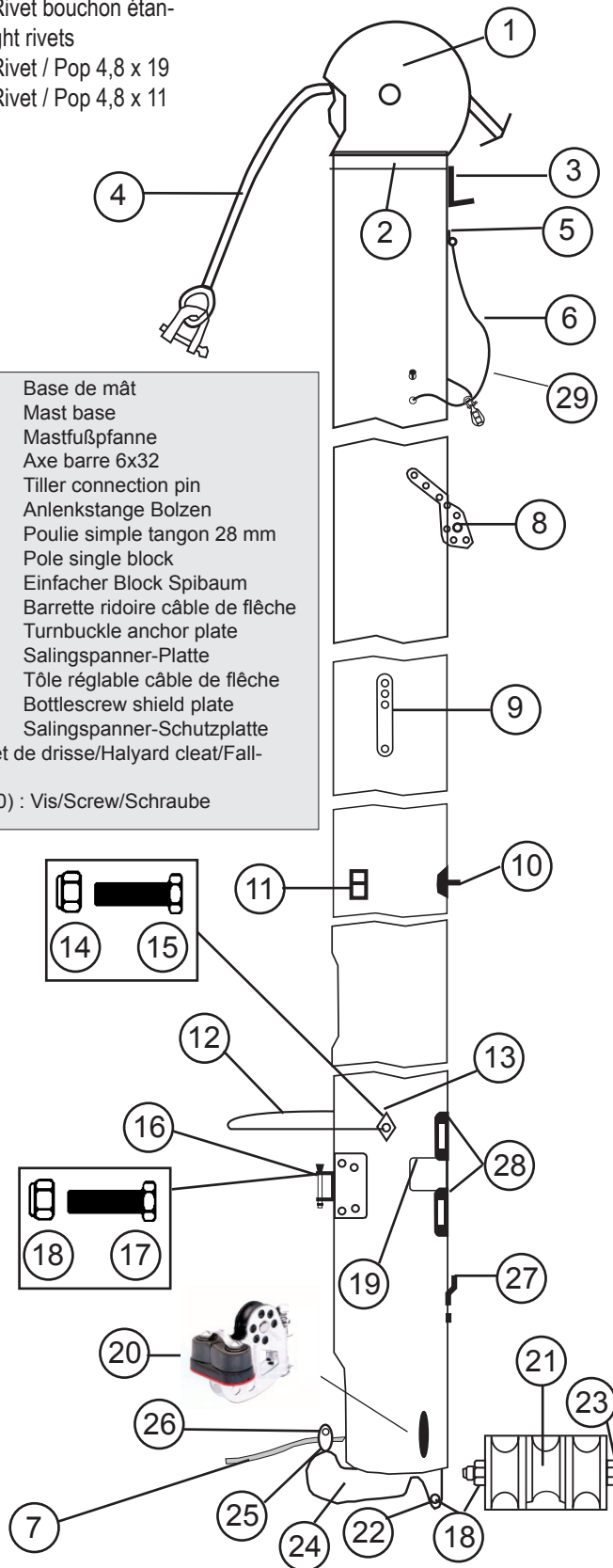

Hobie Cat 18 Pacific
Grand-voile/Main sail/Großsegel

Grand-voile Hobie Cat 18 Pacific
Hobie Cat 18 Pacific main sail
Hobie Cat 18 Pacific Großsege

Blanche/White/Weiss = 18530000
2003 = Jaune&rouge/Yellow&red/ = 18530006

Grand-voile Hobie Pacific Sport
Hobie Pacific Sport main sail
Hobie Pacific Sport Großsegel

Blanche/White/Weiss 18530030

Lattes de grand-voile Hobie Cat 18 Pacific
Hobie Cat 18 Pacific main battens
Hobie Cat 18 Pacific Großsegel-Latten

18534010 (2002)	18534020 (2003)	
#1 : 18534011	18534021	= 2280 mm
#2 : 18534012	18534022	= 2240 mm
#3 : 18534013	18534023	= 2210 mm
#4 : 18534014	18534024	= 2110 mm
#5 : 18534015	18534025	= 1850 mm
#6 : 18534016	18534026	= 1465 mm
#7 : 18534017	18534027	= 990 mm
#8 : N/A	18534028	= 500 mm

18534030 : Jeu de latte Pacific Sport
 Batten set Pacific Sport
 Lattensatz Pacific Sport

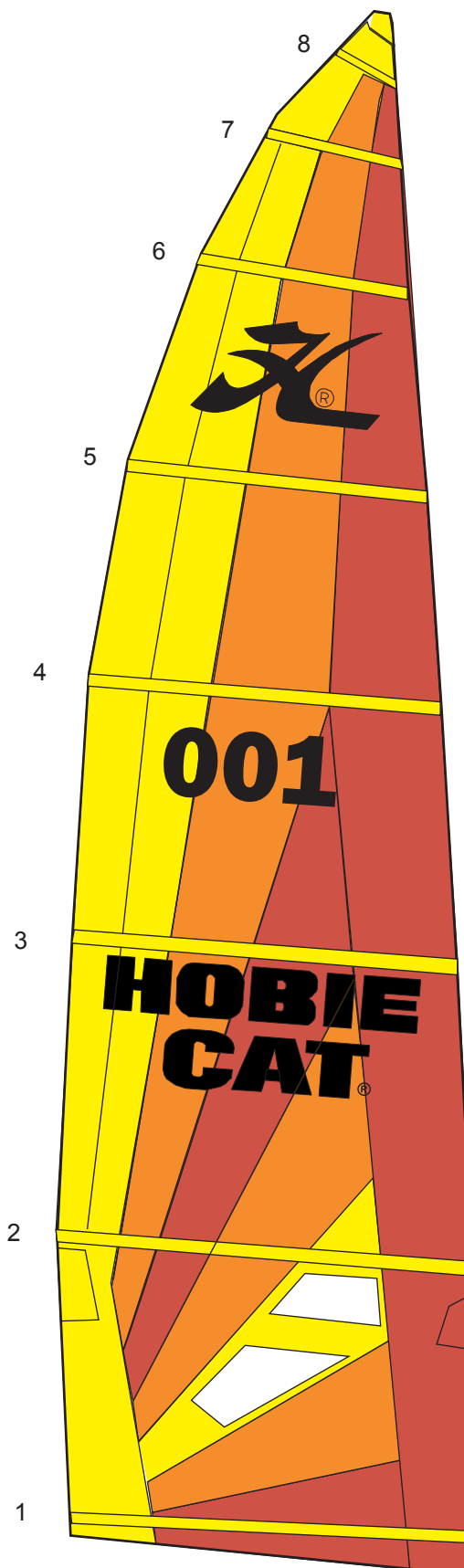

Hobie Cat 18 Pacific Foc/Jib/Fock

18530110 :	Foc blanc (grand modèle) White jib (large) Fock weiß (groß)
18530100 :	Foc blanc White jib Fock weiß
18530106 :	Foc jaune et rouge Jib yellow and red Fock gelb und rot
18570350 :	Accastillage grand foc Rig large jib Ausstattung für großer Fock
18530125 :	Foc jaune Pacific Sport Jib yellow Pacific Sport Fock gelb Pacific Sport

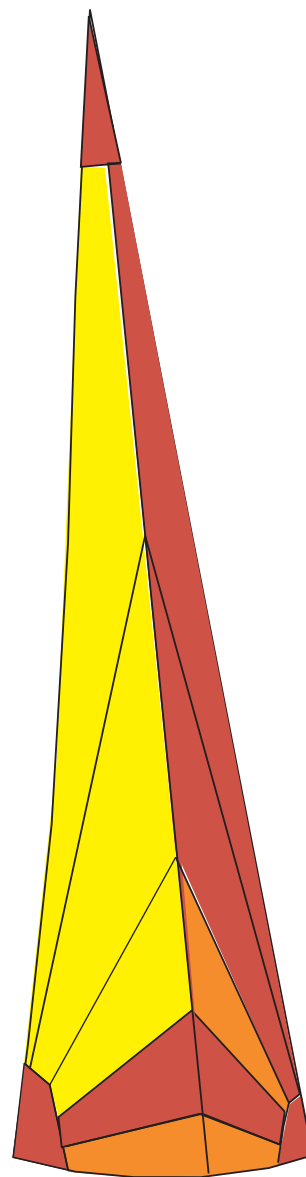

99267465 : Sac spinnaker 18570325 : Accastillage spi + cordages
 Spinnaker bag Spi rig + ropes
 Spitasche Spi takelage + Leinen

Hobie Cat 18 Pacific Kit de spi/Spi kit

Le kit de spi ne peut fonctionner que si
 une bôme est installée
**A boom must be installed before
 using the spinnaker kit**

- 1 - 99220057 : Pontet forgé D5
 Pad-eye
 Gusseisenbeschlag
 2 - 99500114 : Poulie Harken H082
 Harken block H082
 Block Harken H082
 3 - 99220036 : Manille 4 mm
 PKG 10
 Shackle 4 mm
 Schäkel 4 mm
 4 - 18080565 : Bride tangon
 Pole bridle
 Spibaum-Hanepot
 5 - 18062635 : Tangon de spi
 Spi pole
 Spibaum

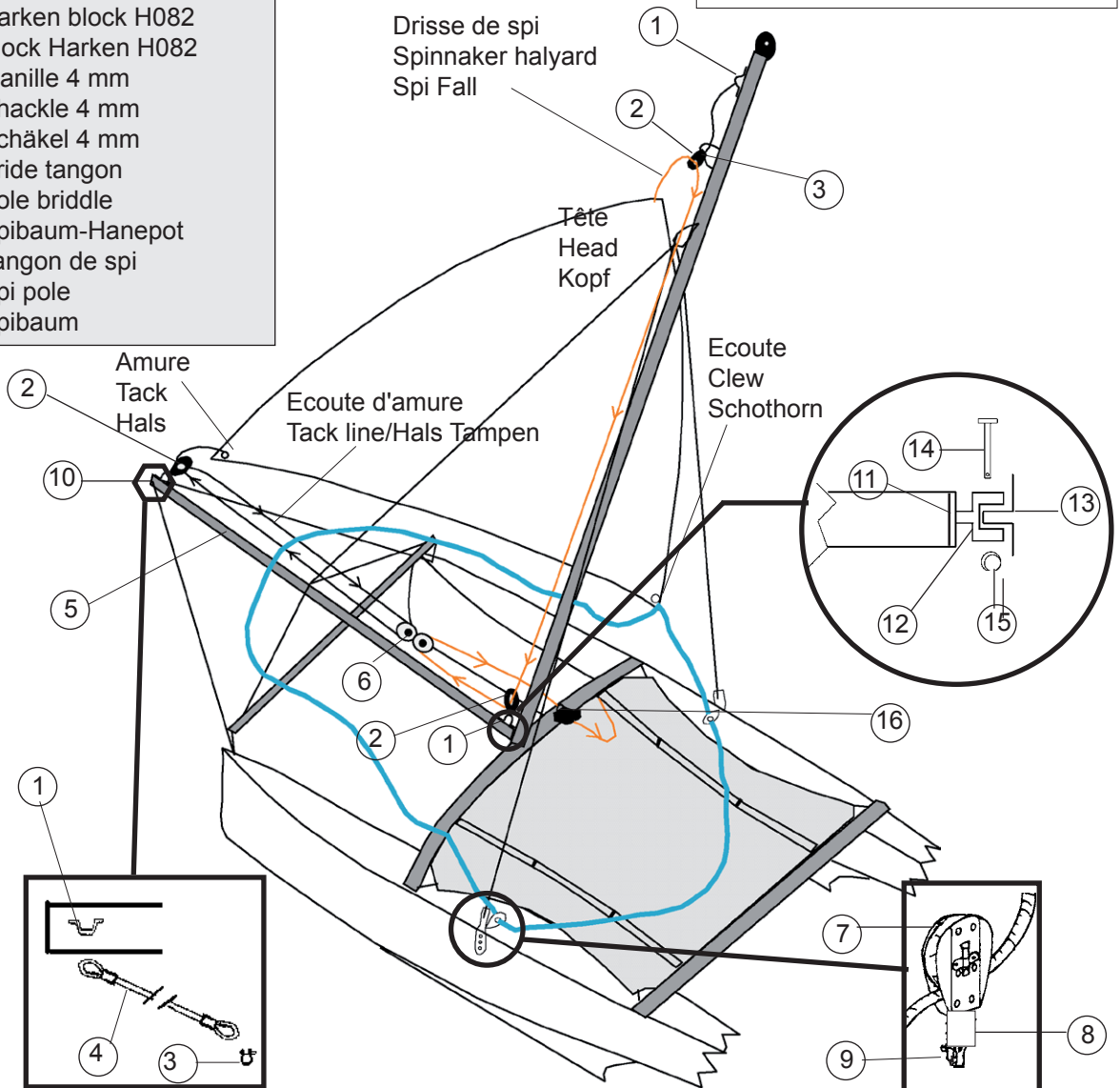

- 6 - 21060060 : Poulie tête-à-tête H114
 Spi block H114
 Block spi H114
 7 - 99501000 : Poulie winch
 Ratchet block
 Knarr-Block
 8 - 99500755 : Ressort poulie écoute foc/spi
 Spi sheet block spring
 Spischothblock-Feder
 9 - 99220035 : Manille lyre 6 mm
 PKG 10
 Shackle 6 mm
 Schäkel 6 mm
 10 - 21041734 : Embout tangon plast.
 PKG 5
 Spi pole end cap
 Endstück Spibaum
 11 - 21062625 : Embout tangon plast. percé
 Spi pole end cap drilled
 Endstück Spibaum gebohrt

- 12 - 16056025 : Articulation tangon
 Spi pole connection
 Verbindung Spibaum
 13 - 18061320 : Chape d'articulation tangon
 Spi pole connection toggle
 Verbindungswirbel Spibaum
 14 - 14061245 : Axe barre
 Connection pin
 Bolzen
 15 - 99220031 : Anneau brisé
 PKG 10
 Split ring
 Splintring
 16- 99500467 : Tourelle taquet carbo
 Cleat
 Klemme

**OPTION
OPTIONAL**

Hobie Cat 18 Pacific
Kit de spi trompette soft
Trumpet soft spi kit

- 18570330 : Accastillage Spinnaker trompette + cordages
Trumpet spinnaker rig bag + lines
Spikanone-Rig + Leine
- 1- 18062635 : Tangon Pacific spi trompette
Spi pole Pacific Trumpet
Trumpet Spibaum Pacific
- 2 - 18080555 : Brides cunningham spi trompette
Pole support wire trumpet
Trumpet Spibaum-Gurtel
- 3 - 99300545 : Cordage spectra D4 blanc
Spectra line D4 trumpet
Spectraleine D4 Trumpet

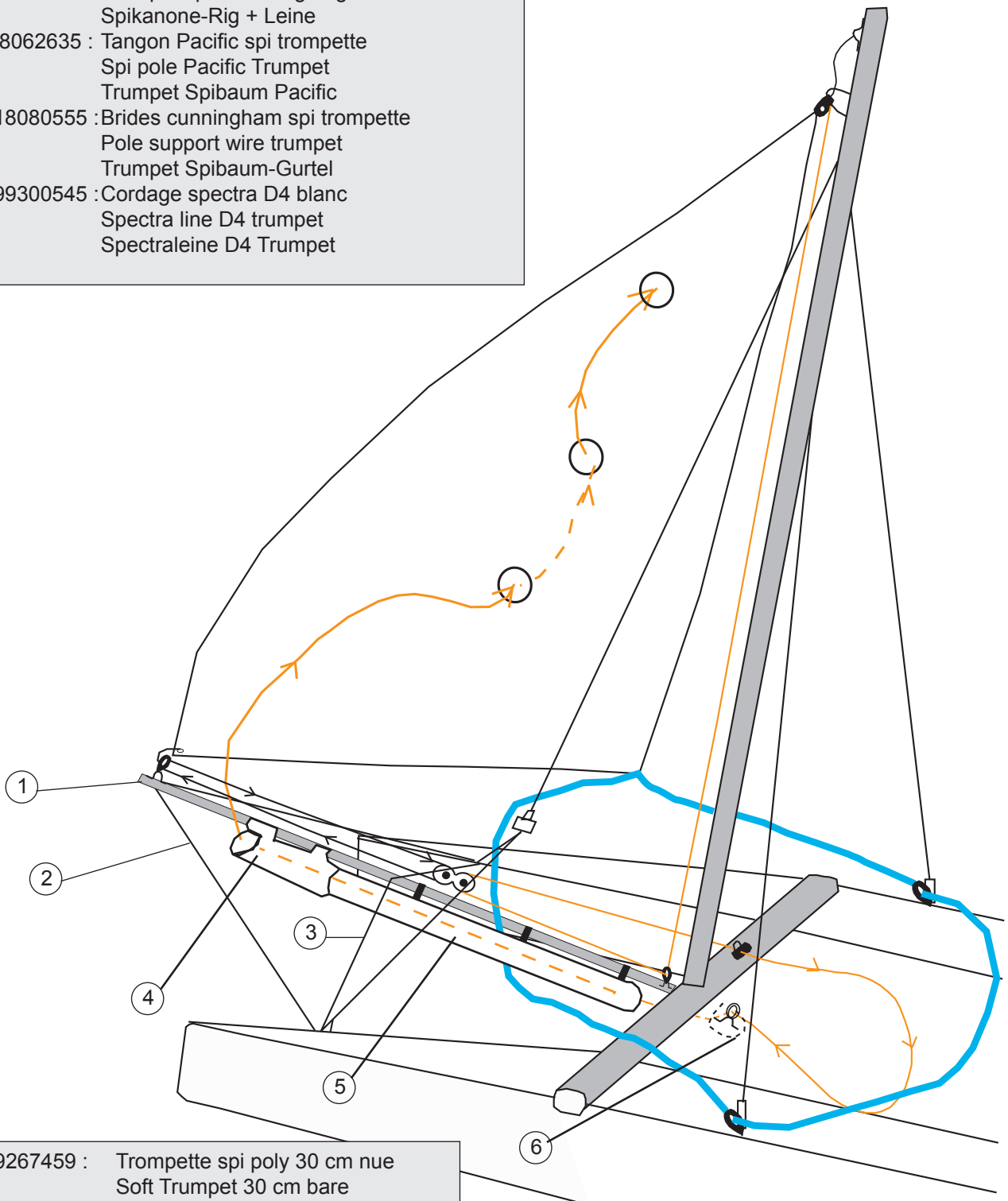

- 4-99267459 : Trompette spi poly 30 cm nue
Soft Trumpet 30 cm bare
Spikanone soft 30 cm rohr
- 5-99267522 : Sac de spi trompette
Trumpet spinnaker bag
Sack für kurzer Spikanone
- 6-18570385 : Accastillage trampolin spi trompette
Tramp rig for trumpet spi
Trumpet Spi klein Teile für Trampoline

**Hobie Cat 18 Pacific
SPINNAKER**

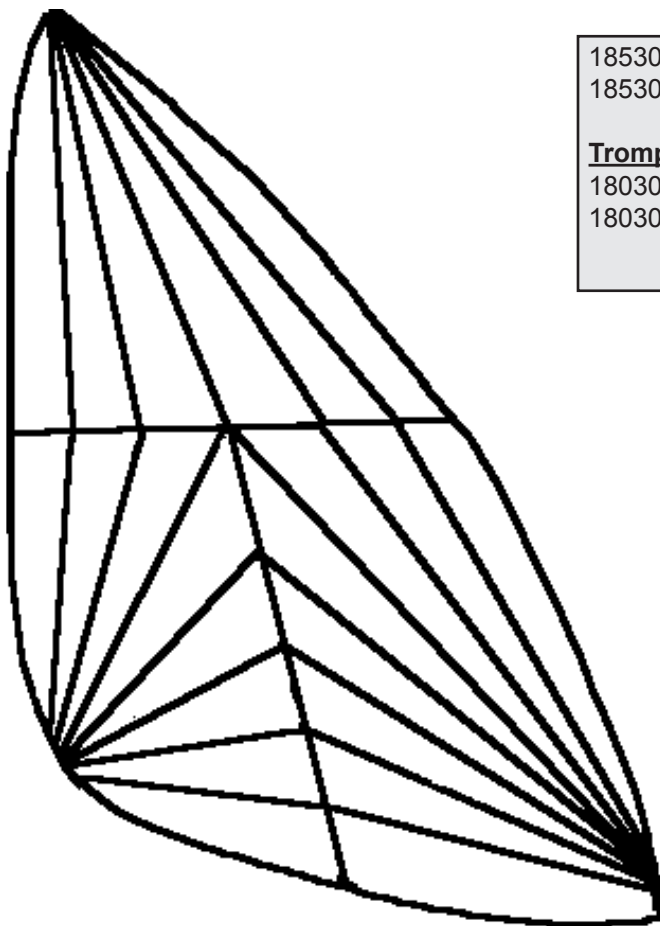

18530200 : Blanc/white/weiß
18530206 : Jaune/yellow/gelb

Trompette/Trumpet/Spikanone
18030197 : Blanc/white/weiß
18030198 : Jaune/Yellow/Gelb

Hobie Cat 18 Pacific Trampoline/Trampoline (Mesh)

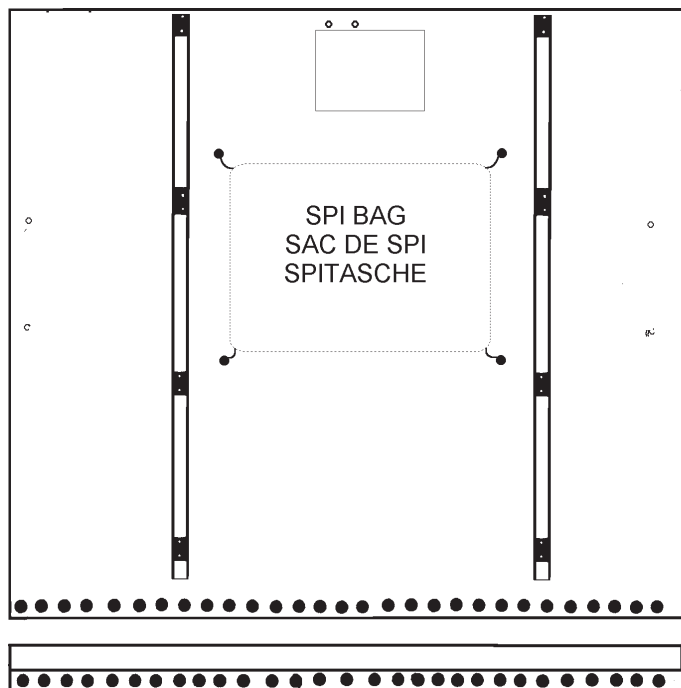

18525800 (2,50 m - 2p ralingue)

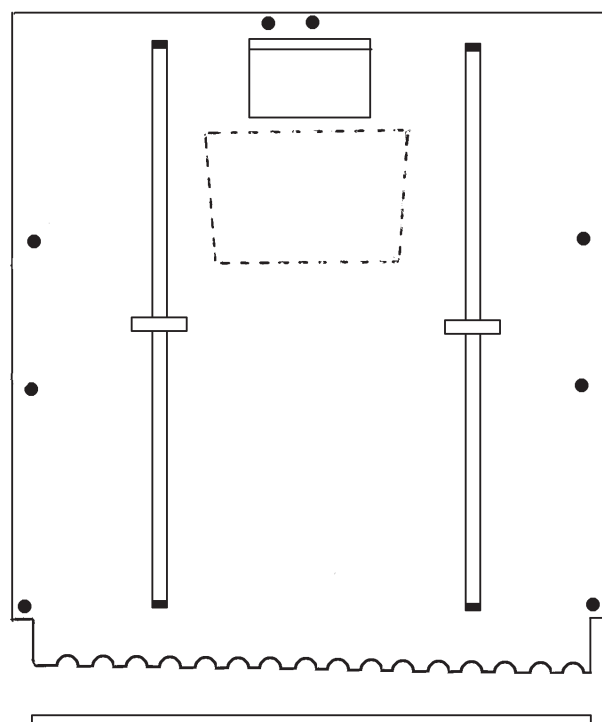

18525850 (2,50 m - 1 p ralingue)

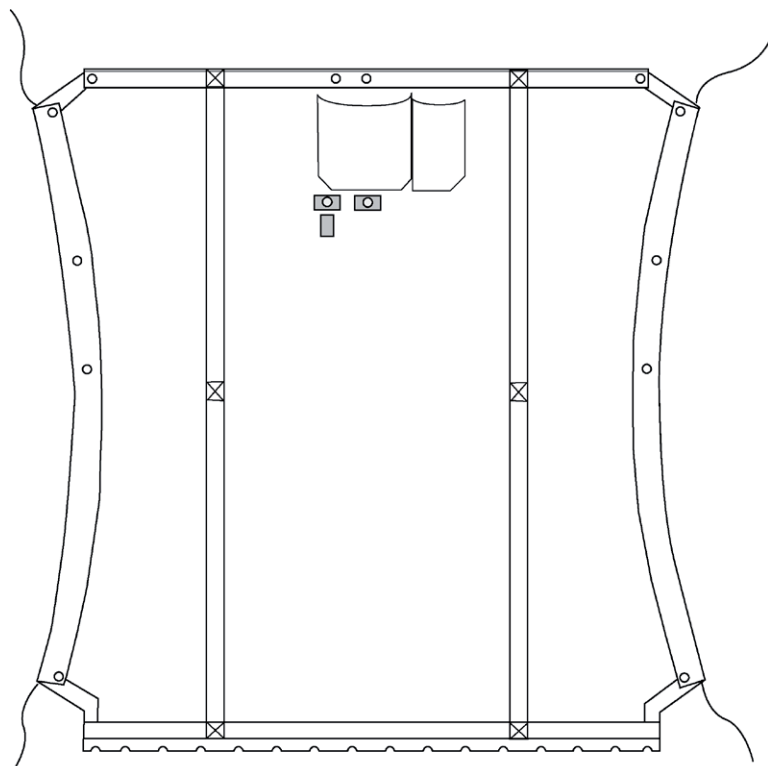

18525855 (2,50 m - 1 p spectra)

18525865 (2,60 m - 1 p spectra)(jusqu'en/up until/bis 2006)

18025855 (2,60 m - 1 p spectra) (à partir de/as from/ab 2007)

- | | |
|------------|--|
| 18525000 : | Jonc Trampoline Pacific (2,50 m)
Fibreglass lacing rod (2,50 m) |
| 18025000 : | Jonc trampoline Tiger (2,60 m)
Fibreglass lacing rod (2,50 m) |
| 99267465 : | Sac de spi (option)
Spinnaker bag (optional)
Spitasche (mit Aufpreis) |
| 18070480 : | Bout de trampoline Vectran
Trampoline lacing Vectran
Trampolineleine Vectran |

Hobie Cat 18 Pacific
Barber de foc/Jib barber hauler

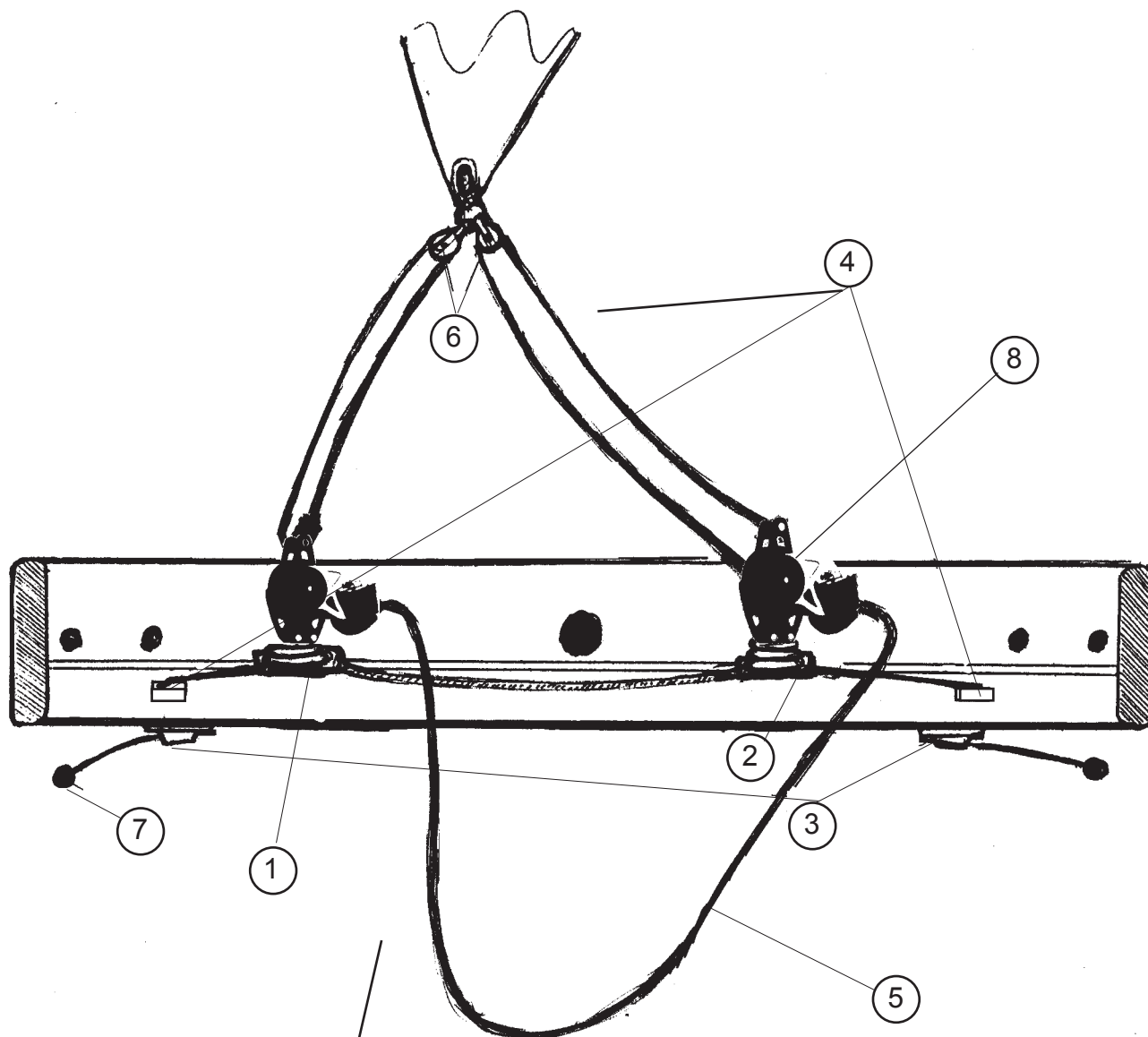

Hobie Cat 18 Pacific : Eclaté de pièces détachées / Illustrated part guide/Explosionszeichnung (2009)

- 1 - 18580055 : glissière Chariot gauche
Jib slideleft
Fockschotschlitten links
- 2 - 18580060 : glissière Chariot droit
Jib slideright
Fockschotschlitten rechts
- 3 - 99500540 : Taquet alu
Clamcleat alu
Klemme Alu
- 4 - 99500545 : Poulie Barber foc
Exit block
Umlenkrolle

- 5 - 18060418 : écoute de foc
Jib sheet
Fockschot
- 6 - 99500114 : Poulie point d'écoute de foc
Jib clew block
Fockschotblock
- 7 - 99500103: Boule d'arrêt
PKG 5
Stop ball
Plastikkugel
- 8 - 99500800 : Poulie de foc + ressort
Jib block assembly
Block mit Splint

Chariot complet/Complete traveller/
Traveler Komplet = N° 8 + 1/2

AVANT 2003
PRIOR 2003
VOR 2003

Hobie Cat 18 Pacific
Palan de grand-voile/Mainsheet system
Großschot-System

99220036 :
PKG 10

Manille Lyre D4
Shackle D4
Schäkel D4

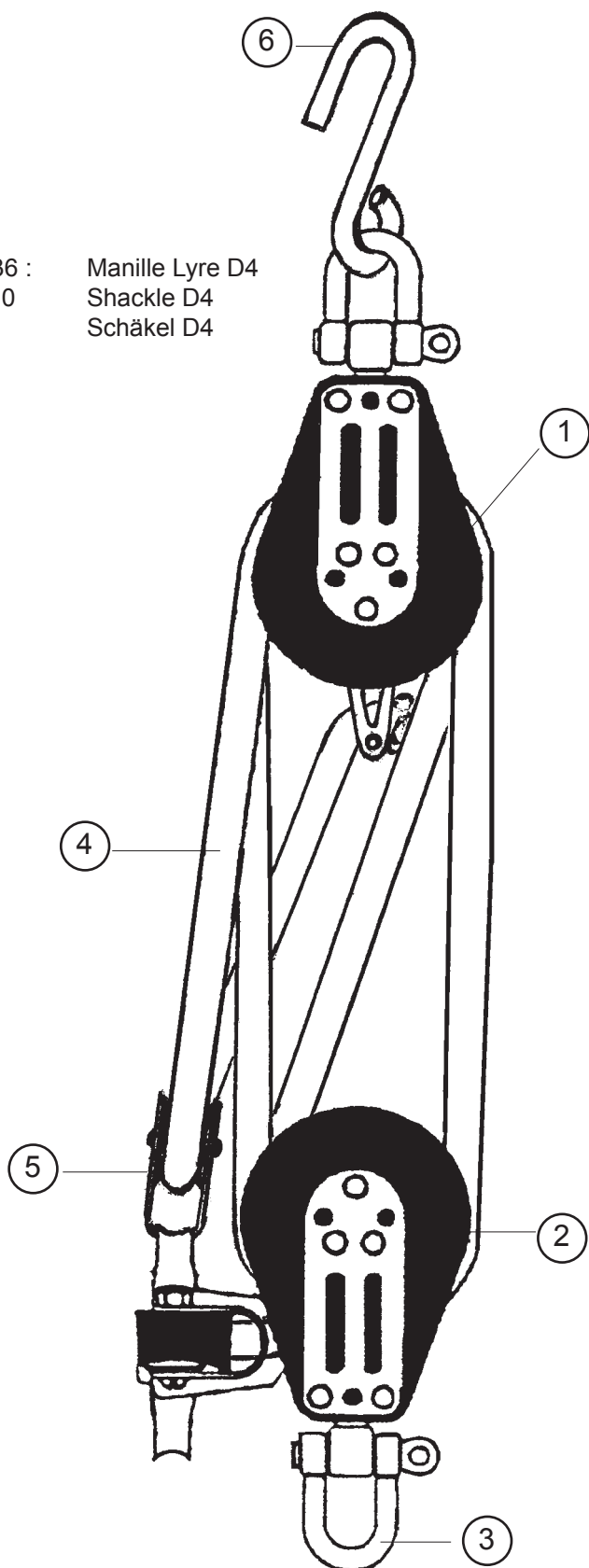

- 1 - 99500367 : Poulie triple ringot
Threefold block with bequet
Dreifacher Block
- 2 - 99500995 : Poulie triple winch
Triple ratchet block
Dreifacher Block
- 3 - 99220042 : Manille de poulie
Block shackle
Blockschäkel
- 4 - 18060419 : Ecoute de grand-voile
Mainsheet
Großschot
- 5 - 99500368 : Poulie simple 7ème brin
Single block
Einzel Block
- 6 - 99500260 : Crochet de grand-voile
PKG 2
Hook mainsheet
Großsegel-Haken

CUNNINGHAM

- 99500115 : : Poulie triple
Triple block
Dreifacher Block
- 99500210 : Crochet
PKG 2
Hook cunningham
Vorliekstrecker-Haken

**DEPUIS 2003
FROM 2003
AB 2003**

Hobie Cat 18 Pacific
Palan de grand-voile/Mainsheet system
Großschot-System

18060419 :
Ecoute de GV
Mainsheet
Großschott



①

②

- | | |
|----------------|---|
| 1 - 99501005 : | Poulie quadri carbo 57 mm
Carbo block fourfold 57 mm
Carbo 4-fach Block 57 mm |
| 2 - 99500136 : | Poulie winch triple
Threefold ratchet block
Dreifacher Knarrblock |

Depuis 2003
From 2003
Ab 2003

Hobie Cat 18 Pacific
BOME/BOOM/BAUM
18512810

99216011 (x10)
Pop 4,8 x 11

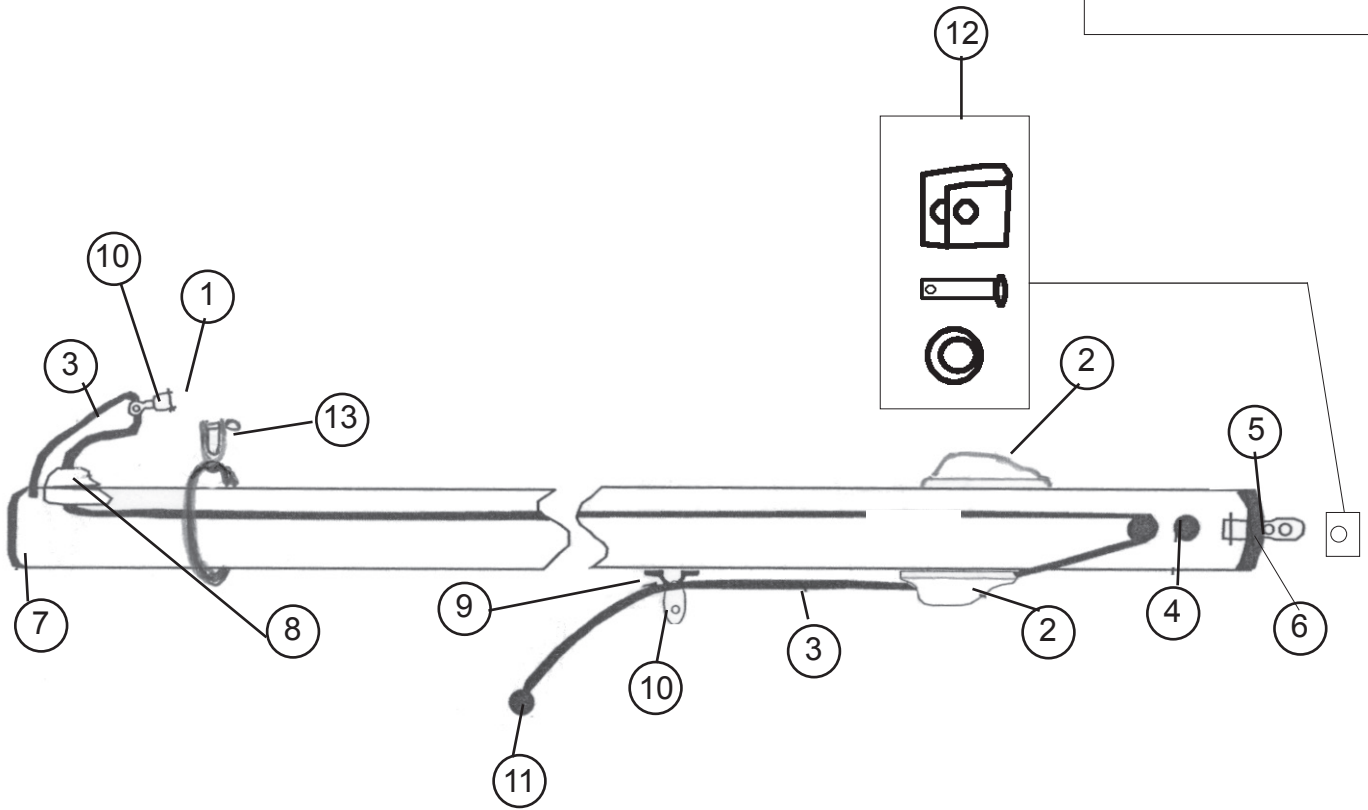

1 - 18042710:	Manille longue Shackle long Schäkel lang
2 - 99500540:	Taquet alu noir Cam cleat aluminium black Klemme aluminium schwarz
3 - 18060412:	Cordage D5 D5 rope Leine D5
4 - 99500490:	Poulie Cheek block Block
5 - 14011820:	Ancrage vit mullet Gooseneck fastening Bauteil f. Lümmelbeschlag
6 - 17569000:	Embout de bôme av. Front boom end cap Baumendkappe vorne
7 - 99220202:	Bouchon ailettes D40 PKG 5 Wing end cap D40 Ablaßschraube D40

8 - 99500545:	Poulie barber Exit block Block
9 - 99220057:	Pontet Eye strap Bügel
10- 99500478:	Poulie simple Simple block Block Einfach
11- 99500103:	Boule d'arrêt PKG 5 Stop ball Kugelstopper
12- 14070352:	Charnière centrale vit mullet Gooseneck vertex Gleiter Lümmelbeschlag
13 - 18042712 :	Anneau + manille (*) Ring + shackle Ring mit Schäkel

(*) supprimé en 2004 / deleted in 2004

18012815 : BOME 18TI COMPLETE 2002
 COMPLETE BOOM 18TI 2002
 BAUM KOMPLETT 18TI 2002

**Hobie Pacific (Option
 Pacific Sport)**
 Bôme/Boom/Baum

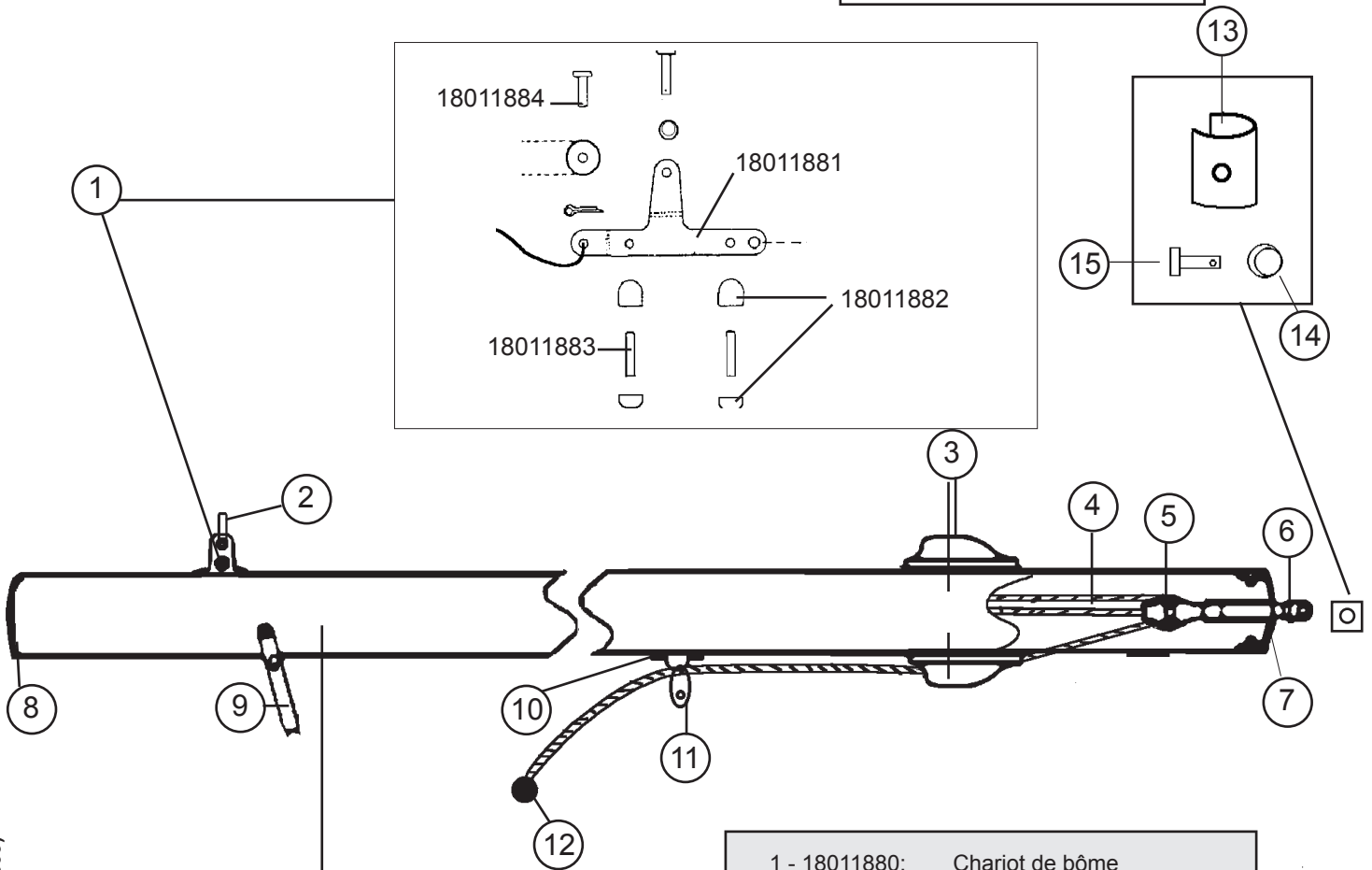

Hobie Cat 18 Pacific : Eclaté de pièces détachées / Illustrated part guide/Explosionszeichnung (2009)

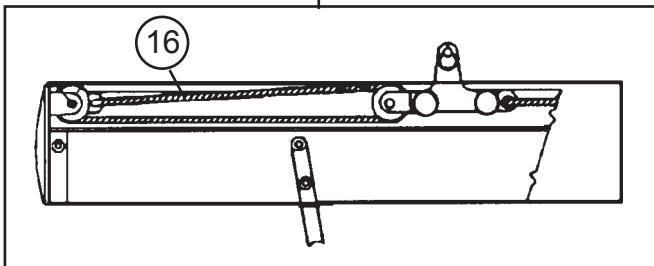

11- 99500105:	Poulie simple ringot Simple block Block Einfach
12- 99500203: PKG 5	Boule d'arrêt Stop ball Kugelstopper
13- 14070351:	Charnière vit mulet Hinge vertex assembly. Lümmelbeschlag-Verbindungs kit
14- 99220231 : PKG 10	Anneau brisé Split ring Ringsplint
15- 99220034: PKG 10	Axe percé latte ridoir Clevis pin Bolzen f. Locheisen gebohrt
16- 18060411:	Sandow Sandow Gummi

1 - 18011880:	Chariot de bôme Outhall car assembly Baumtraveller
2 - 99220035: PKG 10	Manille lyre 6 mm Shackle 6 mm Schäkel 6 mm
3 - 99500540:	Taquet alu Cam cleat aluminium Klemme aluminium
4 - 18060412:	Cordage D5 D5 rope Leine D5
5 - 17070150:	Poulie étarquage simple Simple block Block einfach
6 - 14011820:	Ancrage vit mulet Gooseneck fastening Bauteil f. Lümmelbeschlag
7 - 18000090:	Embout de bôme av. Front boom end cap Baumendkappe vorne
8 - 18000095:	Embout de bôme arrière. Boom rear end cap Baumendkappe hinten
9 - 14011830:	Collier de bôme Block hanger Baumblock Beschlag
10- 99220057:	Pontet D5 Pad-eye Bügel



**OPTION
OPTIONAL**

18062950
gauche
left
links

Hobie PACIFIC
Sport Wing Assembly
Ailes Sport
Sport-Wing

18062955
droit
right
rechts

Assise aile sport
Wing tube sport

18062960= Gauche/left/links
18062965 = Droite/right/rechts

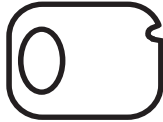

18062741
Bouchon de trav. AV gauche
Beam cap front left
Vorderholmendstück links

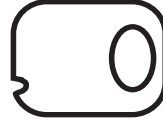

18062742
Bouchon de traverse AV droit
Beam cap front right
Vorderholmendstück rechts

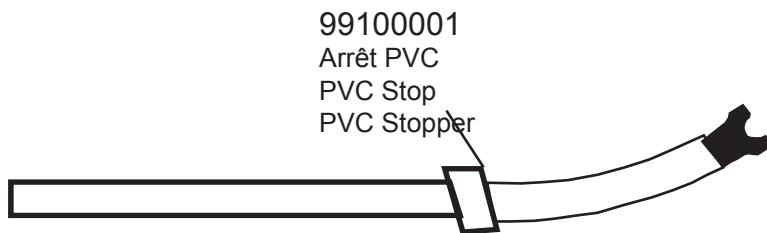

18062930
Bras d'aile sport complet
Wing arm sport complete
Wingarm Sport Komplett

99100001
Arrêt PVC
PVC Stop
PVC Stopper

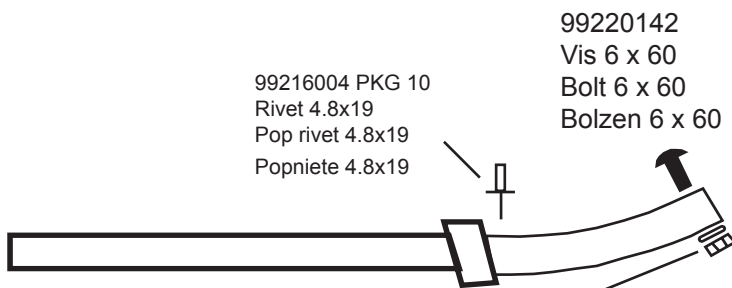

99216004 PKG 10
Rivet 4.8x19
Pop rivet 4.8x19
Popniete 4.8x19

99220142
Vis 6 x 60
Bolt 6 x 60
Bolzen 6 x 60

99220032 PKG 10
Rondelle inox 6 mm
Washer stainless 6 mm
Unt.Scheibe inox 6 mm

18041733
Casting embout wing
End casting wing
Gusseisen Endstück
Wing

99216020 PKG 10
Rivet 4,8 x 14
Rivet 4,8 x 14
Popniete 4,8 x 14

99220019 PKG 10
Ecrrou indessérable 6 mm
Nylstop nut 6 mm
Selbstsichernde Mutter 6 mm



18062743
Bouchon de trav. AR gauche
Boom cap rear left
Achterholmendstück links



18062744
Bouchon de traverse AR droit
Boom cap rear right
Achterholmendstück rechts

17025810
Embout plast. 48 mm
End cap plast. 48 mm
Endstück 48 mm

99506050 PKG 10
Neoprene
Neoprene
Antirutsch-belag

- 18562910 : Aile gauche s/s trampoline
Left wing w/o trampoline
Wing links o. Trampoline
- 18562920 : Aile droite s/s trampoline
Right wing w/o trampoline
Wing rechts o. Trampoline

**OPTION
OPTIONAL**

Hobie TIGER/PACIFIC
Kit d'ailes classiques/
Classic wings kit
K L PAC

ss tramp./wo tramp./o. Tramp.

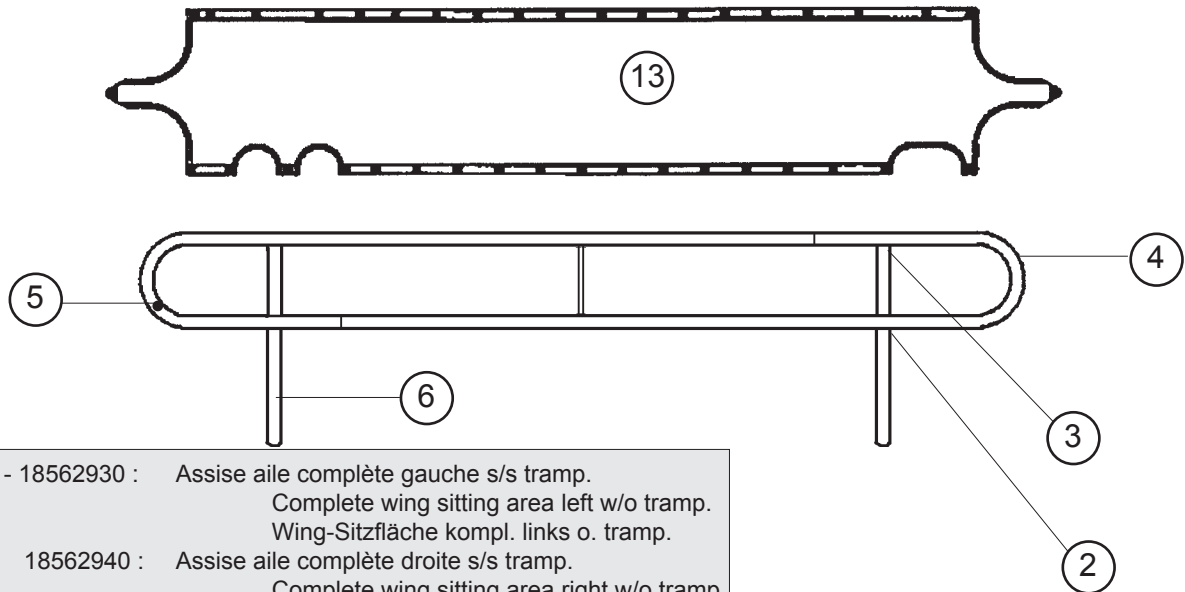

- 1 - 18562930 : Assise aile complète gauche s/s tramp.
Complete wing sitting area left w/o tramp.
Wing-Sitzfläche kompl. links o. tramp.
- 18562940 : Assise aile complète droite s/s tramp.
Complete wing sitting area right w/o tramp.
Wing-Sitzfläche kompl. rechts o. tramp.
- 2 - 21041732 : Casting croix wing
Cross casting wing
Kreuz-Gussecke Wing
- 3 - 21041733 : Casting embout wing
Wing end casting
Gußeckendstück Wing
- 4 - 21062930 : Assise aile nue noire
Wing sitting area bare black
Wing-Sitzfläche roh schwarz
- 5 - 99210048 : Bouchon d'assise
End cap wing sitting area
Endstück Wing-Sitzfläche

- 99210050 : Rivet bouchon étanche
Rivet cap watertight
Niete-Dichtungshülse
PKG 10
- 99216004 : Pop inox TB 4,8 x 19
Pop rivet ss 4,8 x 19
Popniete 4,8 x 19

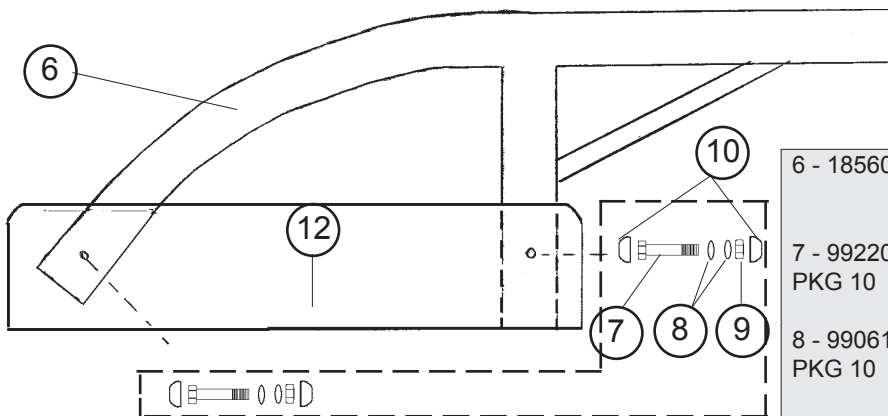

- 12- 18560360 : Fixation bras d'aile avant
Mounting front wing arm
Wingarm-Befestigung vorne
- 18560365 : Fixation bras d'aile arrière
Mounting rear wing arm
Wingarm-Befestigung hinten
- 13- 18025895 : Trampoline d'aile mesh x 2
Wing mesh trampoline x 2
Netztrampoline f. Wing x 2

- 6 - 18560340 : Bras d'aile complet
Wing arm complete
Wingarm komplett
- 7 - 99220044 : Vis TH 8x75
Screw TH 8x75
Schraube 8x75
PKG 10
- 8 - 99061110 : Rondelle D8
Washer D8
Unterlegscheibe D8
PKG 10
- 9 - 99220012 : Ecrou indessérable D8
Nylstop nut D8
Selbstsichernde Mutter D8
PKG 10
- 10- 99210045 : Capuchon de vis TH8
Screw cap
Schraube-Endstück
PKG 10
- 11- 18562970 : Kit montage 2 ailes
Mounting kit 2 wings
Aufbausatz für 2 Wings
(=#7+#8+#9+#10)

18062990
Gauche/Left/Links

Hobie Pacific
Ailes confort + Trampoline
Comfort wings + Trampoline

18062995
Droite/Right/Rechts

**OPTION
OPTIONAL**



18062741
Bouchon de traverse AV gauche
Beam cap front left
Vorderholmendstück links

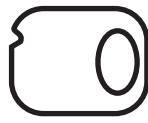

18062742
Bouchon de traverse AV droit
Beam cap front right
Vorderholmendstück rechts

17560340
Bras d'aile confort complet
Comfort wing arm complete
Wingarm comfort komplett

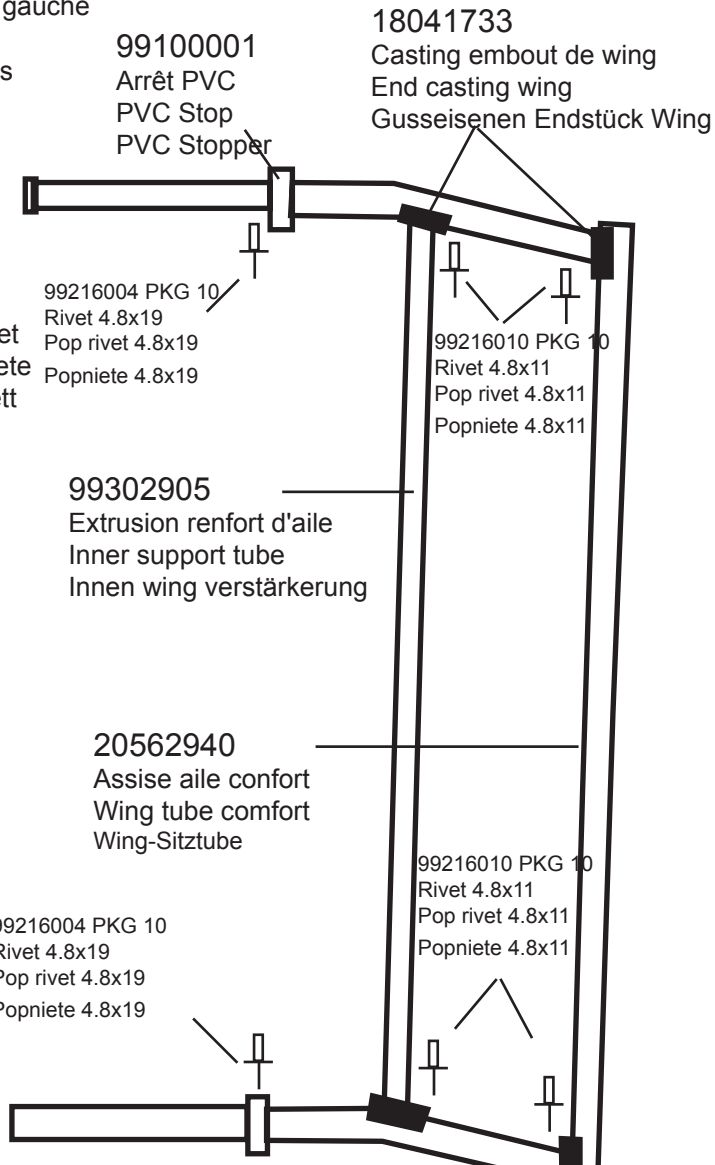

18025900
paire de trampoline droit/gauche
Trampoline set right/left
Trampolinesatz rechts/links

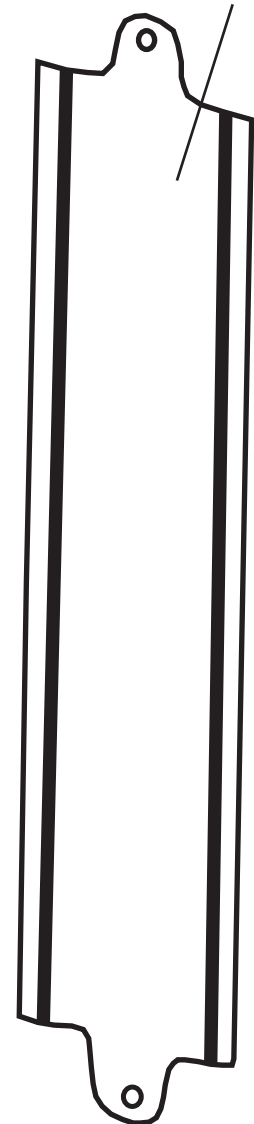

18062743
Bouchon de traverse AR gauche
Beam cap front left
Vorderholmendstück links



18062744
Bouchon de traverse AR droit
Beam cap front right
Vorderholmendstück rechts



17025810
Bouchon à ailettes
End cap
Endstück

99506050 PKG 10
Neoprene anti-derapant
Neoprene anti-skid
Antirutsch-Belag